

ScreenCast

Wireless Display Adapter (JVAW54/56)

4K Wireless Display Adapter (JVAW76)



JVAW54
JVAW56
JVAW76



j5create.com/screencast

EN: Quick Installation Guide
DE: Kurzinstallationsanleitung
FR: Guide d'installation rapide
IT: Guida rapida all'installazione
NL: Snelle installatiegids
ES: Guía de Instalación Rápida
PT: Guia de instalação rápida
SE: Snabbinstallationsguide

Customer Service: **888-988-0488**
Technical Support: **888-689-4088**
Email: **service@j5create.com**

STOP!
If you have any problems with this product, please contact our technical support team for assistance.

TECHNICAL SUPPORT
Customer Service: **888-988-0488**
Technical Support: **888-689-4088**
Email: **service@j5create.com**

SOPORTE TÉCNICO
Número gratuito: +1-888-988-0488
Horario de atención:
Lun-Vier. 10:00 a.m. – 6:00 U.S.A.-E.S.T.
E-mail: service@j5create.com

TECHNISCHE SUPPORT
Kostenloser Anruf bei: +1-888-988-0488
Sprechstunden:
Mon.-Frei. 10:00 – 18:00 U.S.A.-E.S.T.
E-mail: service@j5create.com

テクニカルサポート
お客様相談センター: 03-5540-9010
電子メール: j5_support@solinet.co.jp
テクニカルサポートやその他のご相談は下記の時間帯にございますようお願い申し上げます
営業時間: 平日9:30~11:30/13:30~17:30

TECHNICKÁ PODPORA
Zákaznická linka: 888-988-0488
Technická podpora: 888-689-4088
E-mail: service@j5create.com

HDMI is a trademark of HDMI Licensing Administrator, Inc. Its affiliates or its respective owners, registered or used in many jurisdictions worldwide. USB is a trademark of USB Implementers Forum, Inc. Its affiliates or its respective owners, registered or used in many jurisdictions worldwide. Android, Google, and Pixel are trademarks of Google LLC. Its affiliates or its respective owners, registered or used in many jurisdictions worldwide. iOS is a trademark of Apple Inc., registered in the U.S. and other countries. Samsung, LG, and Smart View are trademarks of Samsung Electronics Co., Ltd. Its affiliates or its respective owners, registered or used in many jurisdictions worldwide. LG is a trademark of LG Electronics, its affiliates or its respective owners, registered or used in many jurisdictions worldwide. Other trademarks and trade names may be used in this document to refer to their products and services. All trademarks and trade names are the property of their respective owners. All other trademarks, product and service names and/or any identification purposes only. Use of these names, logos, and brands does not imply endorsement. We disclaim any interest in the marks of others.

FCC Warning Statements
This equipment has been tested and found to comply with the limits for a Class B digital device, pursuant to part 15 of the FCC Rules. These limits are designed to provide reasonable protection against harmful interference in a residential installation. This equipment generates, uses and can radiate radio frequency energy and, if not installed and used in accordance with the instructions, may cause harmful interference to radio communications. However, there is no guarantee that interference will not occur in a particular installation. If this equipment does cause harmful interference to radio or television reception, which can be determined by turning the equipment off and on, the user is encouraged to try to correct the interference by one or more of the following measures:
• Reorient or relocate the receiving antenna.
• Increase the separation between the equipment and receiver.
• Connect the equipment into an outlet on a circuit different from that to which the receiver is connected.
• Consult the dealer or an experienced radio/TV technician for help. This device complies with part 15 of the FCC Rules. Operation is subject to the following two conditions:
(1) This device may not cause harmful interference, and
(2) this device must accept any interference received, including interference that may cause undesired operation, changes or modifications not expressly approved by the party responsible for compliance could void the user's authority to operate the equipment.
• The USB-A port is only for the power supply? If USB-A port connect with a portable device, it will provide the power.

FCC RF Exposure Warning
This equipment should be installed and operated with a minimum distance of 20 centimeters between the radiator and your body.
• The product is restricted for indoor use only.

NCC 警語
依據【低功率射頻器材技術規範】
取得審驗證明之低功率射頻器材，非經核准，公司、商號或使用者均不得擅自變更頻率、加大功率或變更原設計之特性及功能。
低功率射頻器材之使用不得影響飛航安全及干擾合法通信；經發現有干擾現象時，應立即停用，並改善至無干擾時方得繼續使用。
前述合法通信，指依電信管理法規規定作業之無線電通信。
低功率射頻器材須忍受合法通信或工業、科學及醫療用電波輻射性電機設備之干擾。

Limited Warranty
j5create offers a limited 1-year warranty. User's wear & tear damage is not included. The user shall call or email j5create customer service with the defect information of the product and obtain a return authorization number. User is responsible for one-way return freight cost and we will take care of one-way freight back. In order to obtain a return authorization number, users should have the following information handy when calling or emailing the service team:
(i) a copy of the original purchase invoice to verify your warranty
(ii) a product serial number
(iii) a description of the problem
(iv) customer's name, address, and telephone number
j5create does not warrant that the operation of the product will be uninterrupted or error-free. j5create is not responsible for damage arising from failure to follow instructions relating to the product's use. This warranty does not apply to: (a) damaged parts, unless damage has occurred due to a defect in materials or workmanship; (b) cosmetic damage, including but not limited to scratches, dents, and broken plastic on ports; (c) damage caused by use with non-j5create products; (d) damage caused by natural disasters; (e) damage caused by human misuse (loss, accident, abuse, misuse or other external causes); (f) damage caused by operating the product outside the permitted or intended uses described by j5create; (g) damage caused by service (including upgrades and expansions) performed by anyone who is not a representative of j5create or a j5create Authorized Service Provider; (h) a product or part that has been modified to alter functionality or capability without the written permission of j5create; or (i) any j5create products or components that have been removed or defaced. If such a situation occurs, j5create will calculate the cost of materials and repair for your reference. This warranty is given by j5create in lieu of any other warranties expressed or implied.

Limitation of Warranty
THIS WARRANTY GIVES YOU SPECIFIC LEGAL RIGHTS, AND YOU MAY HAVE OTHER RIGHTS THAT VARY FROM STATE TO STATE (OR BY COUNTRY OR PROVINCE), OTHER THAN AS PERMITTED BY LAW. J5CREATE DOES NOT EXCLUDE, LIMIT OR SUBJECT OTHER RIGHTS YOU MAY HAVE, INCLUDING THOSE THAT MAY ARISE FROM THE NONCONFORMITY OF A SALES CONTRACT. FOR A FULL UNDERSTANDING OF YOUR RIGHTS YOU SHOULD CONSULT THE LAWS OF YOUR COUNTRY, PROVINCE OR STATE. TO THE EXTENT NOT PROHIBITED BY LAW IN YOUR STATE, PROVINCE, JURISDICTION OR COUNTRY, THIS WARRANTY AND THE REMEDIES SET FORTH ARE EXCLUSIVE AND IN LIEU OF ALL OTHER WARRANTIES, REMEDIES AND CONDITIONS, WHETHER ORAL, WRITTEN, STATUTORY, EXPRESS OR IMPLIED.
J5CREATE'S RESPONSIBILITY FOR MALFUNCTIONS AND DEFECTS IN HARDWARE AND/OR SOFTWARE IS LIMITED TO REPAIR OR REPLACEMENT AS SET FORTH IN THIS WARRANTY. J5CREATE'S LIABILITY DOES NOT EXTEND BEYOND THE REMEDIES PROVIDED FOR IN THIS LIMITED WARRANTY, AND J5CREATE DOES NOT ACCEPT LIABILITY FOR CONSEQUENTIAL OR INCIDENTAL DAMAGES. FOR THIRD-PARTY CLAIMS AGAINST YOU FOR DAMAGES, FOR PRODUCTS NOT BEING AVAILABLE FOR USE, OR FOR LOST OR DAMAGED DATA OR SOFTWARE, J5CREATE DOES NOT WARRANT THAT THE OPERATION OF ANY J5CREATE PRODUCT WILL BE UNINTERRUPTED OR ERROR FREE.
J5CREATE'S LIABILITY IN ANY SITUATION WILL BE NO MORE THAN THE AMOUNT YOU PAID FOR THE SPECIFIC PRODUCT THAT IS THE SUBJECT OF A CLAIM. THIS IS THE MAXIMUM AMOUNT FOR WHICH WE ARE RESPONSIBLE, EXCEPT FOR THE EXPRESS WARRANTIES CONTAINED IN THIS WARRANTY AND TO THE EXTENT NOT PROHIBITED BY LAW. J5CREATE DISCLAIMS ALL OTHER WARRANTIES AND CONDITIONS, EXPRESS OR IMPLIED, STATUTORY OR OTHERWISE, INCLUDING WITHOUT LIMITATION, WARRANTIES OF MERCHANTABILITY, MERCHANTABLE QUALITY AND FITNESS FOR A PARTICULAR PURPOSE AND WARRANTIES AND CONDITIONS AGAINST HIDDEN OR LATENT DEFECTS. SOME STATES, PROVINCES, JURISDICTIONS OR COUNTRIES DO NOT ALLOW DISCLAIMERS OF IMPLIED WARRANTIES AND CONDITIONS, SO THIS DISCLAIMER MAY NOT APPLY TO YOU.
TO THE EXTENT SUCH WARRANTIES AND CONDITIONS CONTRADICT UNDER THE LAWS OF THE UNITED STATES, CANADA (AND ITS PROVINCES) OR OTHERWISE, J5CREATE LIMITS THE DURATION AND REMEDIES OF SUCH WARRANTIES AND CONDITIONS TO THE DURATION OF THIS EXPRESS LIMITED WARRANTY AND, AT J5CREATE'S OPTION, REPAIR OR REPLACEMENT SERVICES. SOME STATES, PROVINCES, JURISDICTIONS OR COUNTRIES MAY NOT ALLOW LIMITATIONS ON HOW LONG AN IMPLIED WARRANTY OR CONDITION MAY LAST, SO THE LIMITATION DESCRIBED ABOVE MAY NOT APPLY TO YOU.
NO WARRANTIES OR CONDITIONS, WHETHER EXPRESS OR IMPLIED, WILL APPLY AFTER THE LIMITED WARRANTY PERIOD HAS EXPIRED. SOME STATES, PROVINCES, JURISDICTIONS OR COUNTRIES DO NOT ALLOW LIMITATIONS ON HOW LONG AN IMPLIED WARRANTY OR CONDITION LASTS, SO THIS LIMITATION MAY NOT APPLY TO YOU.
WARRANTY SUPPORT ONLY APPLIES WHEN THE COVERED PRODUCT IS LOCATED WITHIN THE COUNTRY IN WHICH J5CREATE ORIGINALLY SOLD THE SYSTEM, AS REFLECTED IN J5CREATE'S RECORDS. IF YOU NEED SUPPORT FOR THE PRODUCT OUTSIDE OF THE COUNTRY OF ORIGIN (FOR EXAMPLE, WHILE TRAVELING, OR IF THE SYSTEM HAS BEEN RELOCATED TO A NEW COUNTRY), THEN J5CREATE MAY OFFER YOU OTHER SUPPORT OPTIONS FOR AN ADDITIONAL CHARGE.

For more information please visit our website at <http://www.j5create.com>
Copyright© 2022 j5create. All rights reserved. All trade names are registered trademarks of their respective owners. Features and specifications are subject to change without notice. Product may not be exactly as shown in the diagrams.
202203-1V2

English

Connect to Your TV and Power
Plug the HDMI™ connector into an available HDMI™ port on the TV/display
Plug the USB™ connector into an available USB™ Type-A port on your TV (USB™ extension cable included)
* If a USB™ port is not available on your TV, you can connect it into a wall outlet using a USB™ power adapter.
JVAW54/56

(Optional) Position the ScreenCast for an Optimal Streaming Experience
The USB™ connector can be attached to your TV with the double-sided adhesive strip that is included. The strip is for single-use and can be removed. We **DO NOT** recommend placing the USB™ connector behind the TV or inside a TV cabinet. Doing so may cause a weak signal or loss of signal.
JVAW76

Adhesive Strip Instructions (JVAW54/56)

- Choose a flat surface to attach the USB™ connector. Make sure the area is clean before attaching.
- Remove the liner from the double-sided adhesive strip. Press adhesive to the bottom of the USB™ connector.
- Remove the other liner. Firmly press the USB™ connector to the desired location for 30 seconds.

Power on TV and Select Input
Turn on your TV to power up the ScreenCast and select the input until you see the setup screen. In your TV case, please plug the USB™ cord into a USB™ power adapter and connect it to an outlet.

TECHNISCHE SUPPORT
Kostenloser Anruf bei: +1-888-988-0488
Sprechstunden:
Mon.-Frei. 10:00 – 18:00 U.S.A.-E.S.T.
E-mail: service@j5create.com

TECHNICAL SUPPORT
Kostenloser Anruf bei: +1-888-988-0488
Sprechstunden:
Mon.-Frei. 10:00 – 18:00 U.S.A.-E.S.T.
E-mail: service@j5create.com

TECHNICKÁ PODPORA
Zákaznická linka: 888-988-0488
Technická podpora: 888-689-4088
E-mail: service@j5create.com

Wireless Internet Setup

Go to your device's wireless Internet settings and search for the ScreenCast's SSID. Connect with the ScreenCast's SSID and input the password. The PW number is shown below the SSID on the home screen.

SSID: ScreenCast_XXXXXX
PW: XXXXXXXXX

• Open your web browser and go to <http://192.168.203.1> and enter the admin gateway. Choose wireless Internet settings and search for your router's SSID. Select your wireless Internet and input the password. The Admin gateway will disconnect when the ScreenCast is connecting to your wireless Internet.

• Wireless Internet settings success

• Wireless Internet settings incomplete

How to Mirror your device

Android™
Smart View Screen Share Cast
Drag down the quick settings menu and find the screen mirror function, then select the ScreenCast's device name.

iOS®
Screen Mirroring ScreenCast_XXXXXX
Swipe to open the Control Center and start "Screen Mirroring" by selecting the ScreenCast's device name.

macOS®
Start "AirPlay™" from the menu bar by selecting the ScreenCast's device name.

Windows®
PC screen only
Search for wireless display and enable it.
Search for ScreenCast_XXXXXX
Click on ScreenCast_XXXXXX
Click on Connect to wireless display

Firmware Update

Notification for Firmware Update:
If a firmware update available, you will receive a notice on the top where the ScreenCast indicates the connection status.

Auto firmware upgrade
WARNING: After 100% download please DO NOT POWER OFF. Wait for the system to reboot.

Download firmware (85%) > **Upgrade firmware** (35%)

Manual firmware upgrade
WARNING: After 100% download please DO NOT POWER OFF. Wait for the system to reboot.

To update the firmware of your ScreenCast, please follow the instructions below:

SSID: ScreenCast_XXXXXX
PW: XXXXXXXXX

Download firmware (85%) > **Upgrade firmware** (35%)

Need more help setting up the ScreenCast?
Visit j5create.com/screencast

Deutsch

Connect to Your TV and Power
Schließen Sie den HDMI™-Stecker an einen freien HDMI™-Anschluss am Fernseher/Display an.
Verbinden Sie den USB™-Stecker mit einem freien USB™-Type-A-Anschluss an Ihrem Fernseher (USB™-Verlängerungskabel im Lieferumfang enthalten)
* Falls kein USB™-Anschluss an Ihrem Fernseher verfügbar ist, können Sie ihn über ein USB™-Netzteil an eine Steckdose anschließen.
JVAW54/56

(Optional) ScreenCast für optimale Streaming-Erlebnis positionieren
Der USB™-Stecker kann mit dem im Lieferumfang enthaltenen doppelseitigen Klebstreifen an Ihrem Fernseher befestigt werden. Der Streifen ist für den einmaligen Gebrauch und kann entfernt werden. Wir empfehlen, den USB™-Stecker NICHT hinter dem Fernseher oder in einem Fernseherschrank zu platzieren. Andernfalls kann dies zu einem schwachen Signal oder Signalverlust führen.
JVAW76

Anweisungen zum Klebstreifen (JVAW54/56):

- Wählen Sie eine flache Stelle zur Anbringung des USB™-Steckers. Achten Sie vor der Anbringung darauf, dass die Fläche sauber ist.
- Entfernen Sie die Folie vom doppelseitigen Klebstreifen. Drücken Sie den Klebstreifen an die Unterseite des USB™-Anschlusses.
- Entfernen Sie die andere Folie. Drücken Sie den USB™-Anschluss 30 Sekunden an die gewünschte Stelle.

Fernseher einschalten und Quelle wählen
Schalten Sie zur Inbetriebnahme von ScreenCast Ihren Fernseher ein und wählen Sie den Eingang, bis Sie den Einrichtungsbildschirm sehen
* Falls Ihr Fernseher schwarz bleibt, liefert Ihr Fernseher möglicherweise nicht genügend Strom. In diesem Fall schließen Sie das USB™-Kabel an ein USB™-Netzteil an und verbinden dieses mit einer Steckdose.

TECHNISCHE SUPPORT
Kostenloser Anruf bei: +1-888-988-0488
Sprechstunden:
Mon.-Frei. 10:00 – 18:00 U.S.A.-E.S.T.
E-mail: service@j5create.com

TECHNICAL SUPPORT
Kostenloser Anruf bei: +1-888-988-0488
Sprechstunden:
Mon.-Frei. 10:00 – 18:00 U.S.A.-E.S.T.
E-mail: service@j5create.com

TECHNICKÁ PODPORA
Zákaznická linka: 888-988-0488
Technická podpora: 888-689-4088
E-mail: service@j5create.com

WLAN-Einstellungen

Drahtlose-Internet-Einstellungen Ihres Smart-Gerätes aufrufen und nach SSID von ScreenCast suchen. Mit SSID von ScreenCast verbinden und das Kennwort eingeben. Das PW wird neben der SSID am Startbildschirm angezeigt.

SSID: ScreenCast_XXXXXX
PW: XXXXXXXXX

• Ihren Webbrowser öffnen und gehen Sie auf: <http://192.168.203.1> und Admin-Gateway aufrufen. Drahtlose Internet-Einstellungen wählen und die SSID Ihres Routers suchen. Ihr drahtloses Internet wählen und das Kennwort eingeben. Admin-Gateway wird getrennt, wenn ScreenCast eine Verbindung zu Ihrem drahtlosen Internet herstellt.

• Wlan-Einstellung erfolgreich

• Wlan-Einstellung fehlergeschlagen

So spiegeln Sie Ihr Gerät

Android™
Smart View Screen Share Cast
Schnelleinstellungsmenü nach unten ziehen und Bildschirmspiegelung-Funktion finden.

iOS®
Screen Mirroring ScreenCast_XXXXXX
Wischen Sie, um das Control Center zu öffnen, und starten Sie die Bildschirmspiegelung, indem Sie den Geräteanamen des ScreenCast auswählen.

macOS®
„AirPlay™“ aus der Menüliste starten

Windows®
PC screen only
Suchen Sie nach drahtloser Anzeige und aktivieren Sie sie.
Suchen Sie nach ScreenCast_XXXXXX
Klicken Sie auf ScreenCast_XXXXXX
Klicken Sie auf Verbinden Sie drahtlos

Firmware-Aktualisierung

Benachrichtigung zu Firmware-Aktualisierung:
Wenn eine Firmware-Aktualisierung verfügbar ist, erhalten Sie im oberen Bereich, wo ScreenCast den Verbindungstatus anzeigt, einen Hinweis.

Automatische Firmware-Aktualisierung
WARNING: Nach 100% Download bitte NICHT ABSCHALTEN und auf Systemneustart warten.

Firmware herunterladen (85%) > **Firmware aktualisieren** (35%)

Manuelle Firmware-Aktualisierung
WARNING: Nach 100% Download bitte NICHT ABSCHALTEN und auf Systemneustart warten.

Bitte befolgen Sie zur Aktualisierung der Firmware diese ScreenCast-Anweisungen:

SSID: ScreenCast_XXXXXX
PW: XXXXXXXXX

Firmware herunterladen (85%) > **Firmware aktualisieren** (35%)

Sie benötigen mehr Hilfe bei der Einrichtung des ScreenCast?
Besuchen Sie j5create.com/screencast

Français

Connexion de votre téléviseur et alimentation
Branchez le connecteur HDMI™ dans un port HDMI™ disponible sur le téléviseur/écran
Branchez le connecteur USB™ dans un port USB™ Type-A disponible sur votre téléviseur (USB™ câble d'extension inclus)
* Si un port USB™ n'est pas disponible sur votre téléviseur, vous pouvez le connecter à une prise murale à l'aide d'un adaptateur USB™.
JVAW54/56

(Facultatif) Positionner le ScreenCast pour une expérience de streaming optimale
Le connecteur USB™ peut être fixé à votre téléviseur avec la bande adhésive à double face qui est incluse. La bande est à usage unique et peut être enlevée. Nous ne recommandons pas de placer le connecteur USB™ derrière le téléviseur ou à l'intérieur d'une armoire de télévision. Cela peut provoquer un signal faible ou une perte de signal.
JVAW76

Instructions pour la bande Adhésive (JVAW54/56):

- Choisissez une surface plate pour fixer le connecteur USB™. Assurez-vous que la zone est propre avant de l'attacher.
- Retirez le revêtement de la bande adhésive à double face. Appuyez sur l'adhésif au bas du connecteur USB™.
- Retirez l'autre revêtement. Fermeement pressez le connecteur USB™ à l'emplacement souhaité pendant 30 secondes.

Allumez la télévision et sélectionnez votre signal d'entrée
Allumez votre téléviseur pour alimenter le ScreenCast et choisissez le signal d'entrée montrant l'écran d'installation.
* Si votre écran de télévision reste noir, votre téléviseur peut ne pas fournir suffisamment d'énergie. Dans ce cas, veuillez brancher le cordon USB™ dans un adaptateur de puissance USB™ et le connecter à une prise murale.

TECHNISCHE SUPPORT
Kostenloser Anruf bei: +1-888-988-0488
Sprechstunden:
Mon.-Frei. 10:00 – 18:00 U.S.A.-E.S.T.
E-mail: service@j5create.com

TECHNICAL SUPPORT
Kostenloser Anruf bei: +1-888-988-0488
Sprechstunden:
Mon.-Frei. 10:00 – 18:00 U.S.A.-E.S.T.
E-mail: service@j5create.com

TECHNICKÁ PODPORA
Zákaznická linka: 888-988-0488
Technická podpora: 888-689-4088
E-mail: service@j5create.com

Configuration Internet sans fil

Rendez-vous dans les paramètres Internet sans fil de votre appareil et recherchez le SSID de ScreenCast. Connectez-vous avec le SSID de ScreenCast et entrez le mot de passe. Le numéro PW est affiché sous le SSID sur l'écran d'accueil.

SSID: ScreenCast_XXXXXX
PW: XXXXXXXXX

• Ouvrez votre navigateur Web et allez à <http://192.168.203.1> et entrez dans la passerelle admin. Choisissez les paramètres Internet sans fil et recherchez le SSID de votre routeur. Sélectionnez votre Internet sans fil et entrez le mot de passe. La passerelle Admin se déconnectera lorsque le ScreenCast se connecte à votre Internet sans fil.

• Succès des paramètres Internet sans fil

• Paramètres Internet sans fil incomplets

Comment refléter votre appareil

Android™
Smart View Screen Share Cast
Faites glisser le menu paramètres rapide et trouvez la fonction d'écran miroir, puis sélectionnez le nom de l'appareil ScreenCast.

iOS®
Screen Mirroring ScreenCast_XXXXXX
Faites glisser pour ouvrir le centre de contrôle et démarrez "Screen Mirroring" en sélectionnant le nom de l'appareil ScreenCast.

macOS®
Démarrez "Airplay™" à partir de la barre de menu en sélectionnant le nom de l'appareil ScreenCast

Windows®
PC screen only
Rechercher pour afficher et activer l'écran miroir.
Rechercher pour ScreenCast_XXXXXX
Cliquez sur ScreenCast_XXXXXX
Cliquez sur Connecter à l'écran sans fil

Mise à jour du Firmware

Notification pour la mise à jour du Firmware: S'il y a une mise à jour du Firmware disponible, vous recevrez un avis en haut où le ScreenCast indique l'état de connexion.

Mise à jour Automatique du Firmware
WARNING: Nach 100% Download bitte NICHT ABSCHALTEN und auf Systemneustart warten.

Téléchargement du Firmware (85%) > **Mise à jour du Firmware** (35%)

Mise à jour Manuel du Firmware
WARNING: Nach 100% Download bitte NICHT ABSCHALTEN und auf Systemneustart warten.

Pour mettre à jour le firmware de ScreenCast, veuillez suivre les instructions ci-dessous:

SSID: ScreenCast_XXXXXX
PW: XXXXXXXXX

Téléchargement du Firmware (85%) > **Mise à jour du Firmware** (35%)

Besoin de plus d'aide pour mettre en place le ScreenCast?
Visitez j5create.com/screencast

Italiano

Collegamento al televisore e all'alimentazione
Inserire il connettore HDMI™ in una porta HDMI™ disponibile sul televisore/display
Inserire il connettore USB™ in una porta USB™ Type-A disponibile sul televisore (prolunga USB™ inclusa)
* Se una porta USB™ non è disponibile sul televisore, è possibile collegarla a una presa a parete utilizzando un adattatore di alimentazione USB™.
JVAW54/56

(Opzionale) Posizionamento di ScreenCast per un'esperienza di streaming ottimale
Il connettore USB™ può essere collegato al televisore con la striscia adesiva a doppia faccia inclusa. La striscia è monouso e può essere rimossa. **NON** consigliamo di posizionare il connettore USB™ dietro il televisore o all'interno di un mobile TV. Ciò potrebbe causare un segnale debole o una perdita di segnale.
JVAW76

Istruzioni per la striscia adesiva (JVAW54/56):

- Scegliere una superficie piana per collegare il connettore USB™. Assicurarsi che l'area sia pulita prima di attaccarla.
- Rimuovere il rivestimento dalla striscia adesiva. Premere l'adesivo sulla parte inferiore del connettore USB™.
- Rimuovere l'altro rivestimento. Rimuovere con decisione il connettore USB™ nella posizione desiderata per 30 secondi.

Accensione del televisore e selezione dell'ingresso
Accendere il televisore per accendere ScreenCast e selezionare l'ingresso finché non appare la schermata di configurazione.
* Se lo schermo del televisore rimane nero, il televisore potrebbe non fornire energia sufficiente. In tal caso, inserire il cavo USB™ in un adattatore di alimentazione USB™ e collegarlo a una presa.

TECHNISCHE SUPPORT
Kostenloser Anruf bei: +1-888-988-0488
Sprechstunden:
Mon.-Frei. 10:00 – 18:00 U.S.A.-E.S.T.
E-mail: service@j5create.com

TECHNICAL SUPPORT
Kostenloser Anruf bei: +1-888-988-0488
Sprechstunden:
Mon.-Frei. 10:00 – 18:00 U.S.A.-E.S.T.
E-mail: service@j5create.com

TECHNICKÁ PODPORA
Zákaznická linka: 888-988-0488
Technická podpora: 888-689-4088
E-mail: service@j5create.com

Impostazioni Wireless

Andare alle impostazioni Internet wireless del dispositivo smart e cercare l'SSID di ScreenCast. Connettersi con l'SSID di ScreenCast e immettere la password. Il numero PW viene visualizzato accanto all'SSID nella schermata iniziale.

SSID: ScreenCast_XXXXXX
PW: XXXXXXXXX

• Aprire il browser e andare a <http://192.168.203.1> e accedere al gateway amministratore. Scegliere l'impostazione Internet wireless e cercare l'SSID del router. Selezionare la connessione wireless e immettere la password. Il gateway amministratore si disconnette quando ScreenCast si connette a Internet wireless.

• Impostazione Internet wireless riuscita

• Impostazione Internet wireless non riuscita

Come si esegue il mirroring del dispositivo

Android™
Smart View Screen Share Cast
Aprire il menu delle impostazioni rapide e trovare la funzione di mirroring dello schermo.

iOS®
Screen Mirroring ScreenCast_XXXXXX
Scorrere per aprire Centro di controllo e avviare "Mirroring schermo"

macOS®
Avviare "AirPlay™" dalla barra del menu

Windows®
PC screen only
Cercare per visualizzare e attivare l'azione di mirroring.
Cercare per ScreenCast_XXXXXX
Cliccare su ScreenCast_XXXXXX
Cliccare su Connetti a schermo wireless

Aggiornamento del firmware

Notifica per l'aggiornamento del firmware: Se è disponibile un aggiornamento del firmware, nella parte superiore viene visualizzato un avviso in cui ScreenCast indica lo stato della connessione.

Aggiornamento automatico del firmware
AVVERTENZA: Dopo il download al 100%, NON SPENGERE e attendere il riavvio del sistema.

Scarica firmware (85%) > **Aggiorna firmware** (35%)

Aggiornamento manuale del firmware
AVVERTENZA: Dopo il download al 100%, NON SPENGERE e attendere il riavvio del sistema.

Per aggiornare il firmware di ScreenCast, attendere le istruzioni seguenti:

SSID: ScreenCast_XXXXXX
PW: XXXXXXXXX

Scarica firmware (85%) > **Aggiorna firmware** (35%)

Si richiede ulteriore assistenza per configurare ScreenCast?
Visitare il sito j5create.com/screencast

Nederlands

• Aansluiten op uw tv en voeding
 Sluit de HDMI™-connector aan op een beschikbare HDMI™-poort op de tv/display
 Sluit de USB™-connector aan op een beschikbare USB™-Type-A-poort op uw tv (USB™-verlengingsmeelgeleverd)
 * Als er geen USB™-poort beschikbaar is op uw TV, kunt u deze aansluiten op een stopcontact met behulp van een USB™-voedingsadapter.

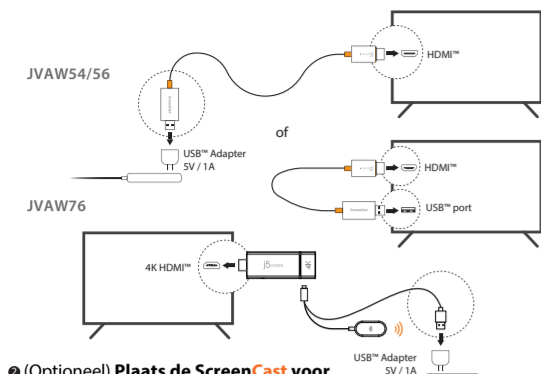

• (Optioneel) Plaats de ScreenCast voor een optimale streaming-ervaring
 De USB™-connector kan aan uw tv worden bevestigd met de meegeleverde dubbelzijdige plakstrip. De plakstrip is bedoeld voor eenmalig gebruik en kan worden verwijderd.
 We raden u AF om de USB™-connector achter de tv of in een tv-kast te plaatsen. Dit kan een zwak signaal of signaalverlies veroorzaken.

Instructies plakstrip (JVAW54/56):

- 1** Kies een vlak oppervlak voor het bevestigen van de USB™-connector. Zorg ervoor dat het gebied schoon is voordat u het bevestigt.
- 2** Verwijder de voering van de dubbelzijdige plakstrip. Druk de plakstrip op de onderkant van de USB™-connector.
- 3** Verwijder de andere voering. Druk gedurende 30 seconden de USB™-connector stevig op de gewenste locatie.

• TV inschakelen en ingang selecteren
 Zet uw tv aan om de ScreenCast in te schakelen en selecteer de ingang tot dat u het instel scherm ziet.
 * Als uw tv-scherm zwart blijft, levert uw tv mogelijk niet voldoende stroom. Steek in dat geval de USB™-kabel in een USB™-voedingsadapter en steek deze in een stopcontact.



USB™ PC HDMI™ 1 HDMI™ 2 HDMI™ 3

Google Pixel™ en meer functies:

Wireless-instellingen
 Ga naar de instellingen voor draadloos internet van uw apparaat en zoek naar de SSID van de ScreenCast. Maak verbinding met de SSID van de ScreenCast en voer het wachtwoord in. Het wachtwoord wordt op het startscherm onder de SSID weergegeven.



Open uw browser en ga naar <http://192.168.203.1>
 voer de Admin gateway in. Kies instellingen voor draadloos internet en zoek naar de SSID van uw router. Selecteer uw draadloze internet en voer het wachtwoord in. De Admin gateway verbreekt de verbinding wanneer de ScreenCast verbinding maakt met uw draadloze internet.

Succès des paramètres Internet sans fil

Paramètres Internet sans fil incomplets

Zo spiegelt u het apparaat

Android™
 Sleep het menu met snelle instellingen omhoog, zoek de schermspieglingsfunctie en selecteer vervolgens de apparaatnaam van ScreenCast.

iOS®
 Swipe om het Control Center te openen en start "Screen Mirroring" door de apparaatnaam van ScreenCast te selecteren.

macOS®
 Start "Airplay™" vanuit de menubalk door de apparaatnaam van ScreenCast te selecteren.

Windows®
 Houd de Windows®-toets + P ingedrukt, selecteer vervolgens "Verbinden met een draadloos beeldscherm" in de selectie van apparaatnaam van ScreenCast.

Firmware-update

Melding voor firmware-update: Als er een firmware-update beschikbaar is, ontvangt u bovenaan een bericht waarin de ScreenCast de verbindingstatus aangeeft.

Automatische firmware-upgrade
 WAARSCHUWING: Schakel het apparaat na 100% downloaden NIET UIT. Wacht totdat het systeem herstart.

Handmatig firmware-upgrade
 WAARSCHUWING: Schakel het apparaat na 100% downloaden NIET UIT. Wacht totdat het systeem herstart.

Volg de onderstaande instructies om de firmware van uw ScreenCast te updaten.

Meer hulp nodig bij het instellen van de ScreenCast? Ga naar j5create.com/screencast

Español

• Conectarse al televisor y la alimentación
 Conecte el conector HDMI™ a un puerto HDMI™ disponible de la pantalla.
 Conecte el conector USB™ a un puerto USB™ Type-A disponible en el televisor (cable de extensión USB™ incluido).
 * Si no hay ningún puerto USB™ disponible en el televisor, puede conectarlo a una toma de corriente de la pared mediante un adaptador de corriente USB™.

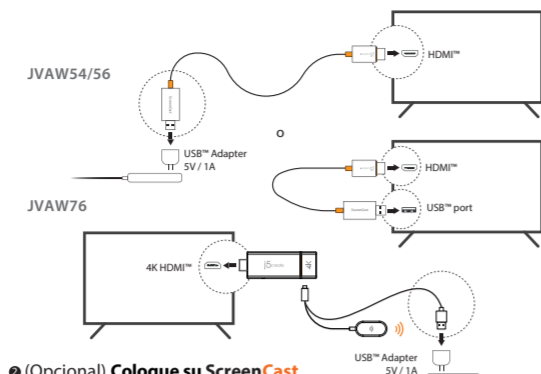

• (Opcional) Coloque su ScreenCast para una experiencia de transmisión óptima
 El conector USB™ se puede conectar al televisor con la tira adhesiva de doble cara que se incluye. La tira es para un solo uso y se puede quitar. NO recomendamos colocar el conector USB™ detrás del televisor o dentro de un mueble de televisión. Si no sigue esta recomendación, la señal resultante puede ser débil o inexistente.

Instrucciones per la striscia adesiva (JVAW54/56):

- 1** Elija una superficie plana para conectar el conector USB™. Asegúrese de que el área esté limpia antes de colocarla.
- 2** Elija una superficie plana para conectar el conector USB™. Asegúrese de que el área esté limpia antes de colocarla.
- 3** Retire el otro revestimiento. Presione firmemente el conector USB™ en la ubicación deseada durante 30 segundos.

• Encender el televisor y seleccionar la entrada
 Encienda el televisor para encender su ScreenCast y seleccione la entrada hasta que vea la pantalla de configuración.
 * Si la pantalla del televisor permanece negra, es posible que dicho televisor no esté suministrando suficiente energía. En este caso, líguese a un adaptador de alimentación USB™ y conéctelo a una toma de corriente.



USB™ PC HDMI™ 1 HDMI™ 2 HDMI™ 3

Cómo reflejar su Google Pixel™ y más funciones:

Configuración Wireless
 Vaya a la configuración de Internet inalámbrica del dispositivo inteligente y busque el SSID de ScreenCast. Conéctese con dicho SSID y escriba la contraseña. El número PW se muestra junto a SSID en la pantalla de inicio.

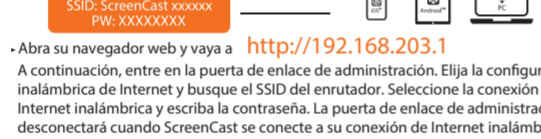

Abra su navegador web y vaya a <http://192.168.203.1>
 A continuación, entre en la puerta de enlace de administración. Elija la configuración de Internet y busque el SSID del enrutador. Seleccione la conexión a Internet inalámbrica y escriba la contraseña. La puerta de enlace de administración se desconectará cuando ScreenCast se conecte a su conexión de Internet inalámbrica.

Configuración inalámbrica de Internet correcta

Error de configuración inalámbrica de Internet

¿Cómo reflejar el dispositivo?

Android™
 Despliegue el menú de configuración rápida y encuentre la función de reflejo de pantalla.

iOS®
 Deslice para abrir el Centro de control e iniciar "Reflejo de pantalla"

macOS®
 Inicie "Airplay™" desde la barra de menús

Windows®
 Mantenga presionadas las teclas Windows® + P y, a continuación, seleccione "Conectarse a una pantalla inalámbrica" y elija el nombre del dispositivo de ScreenCast.

Atualização de firmware

Notificação para atualização de firmware: Si hay una actualización de firmware disponible, recibirá un aviso en la parte superior donde ScreenCast indica el estado de la conexión.

Atualização automática do firmware
 ADVERTENCIA: Después de una descarga del 100%, NO APAGUE LA ALIMENTACIÓN y espere a que el sistema se reinicie.

Atualización manual del firmware
 ADVERTENCIA: Después de una descarga del 100%, NO APAGUE LA ALIMENTACIÓN y espere a que el sistema se reinicie.

Para actualizar el firmware de su ScreenCast, siga estas instrucciones:

¿Necesita más ayuda para configurar ScreenCast? Visite j5create.com/screencast.

Português

• Ligar à TV e fornecer energia
 Ligue o conector HDMI™ a uma porta HDMI™ disponível na TV/monitor
 Ligue o conector USB™ a uma porta USB™ Tipo A disponível na sua TV (cabo de extensão USB™ incluído)
 * Caso não exista uma porta USB™ disponível na sua TV, pode ligar a uma tomada elétrica utilizando um adaptador de corrente USB™.

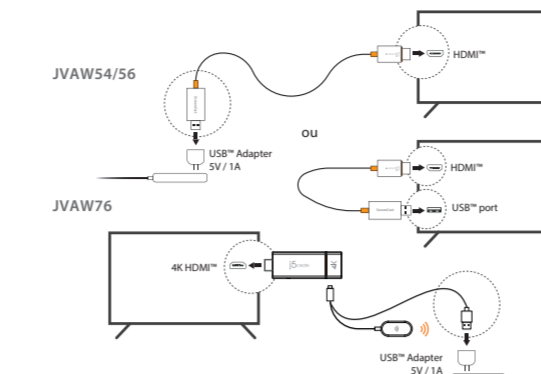

• (Opcional) Posicionar o ScreenCast para uma experiência ideal de transmissão
 O conector USB™ pode ser fixado na sua TV com a fita adesiva de dupla face fornecida com o produto. A fita é de utilização única e pode ser removida. NÃO recomendamos a colocação do conector USB™ atrás da TV ou no interior de um armário de TV. Se o fizer pode originar perda ou degradação do sinal.

Instruções para colocação da fita adesiva (JVAW54/56):

- 1** Escolha uma superfície plana para fixar o conector USB™. Certifique-se de que o local está limpo antes de fixar.
- 2** Remova a película da fita adesiva de dupla face. Cole a fita na parte inferior do conector USB™.
- 3** Remova a outra película. Cole o conector USB™ no local desejado pressionando firmemente durante 30 segundos.

• Ligar a TV e seleccionar a entrada
 Ligue a sua TV para fornecer energia ao ScreenCast e seleccione a entrada para aceder ao ecrã de configuração.
 * Se o ecrã da sua TV não exibir qualquer imagem, a TV poderá não estar a fornecer energia suficiente. Nesse caso, ligue o cabo USB™ a um adaptador de corrente USB™ e ligue-o a uma tomada elétrica.



USB™ PC HDMI™ 1 HDMI™ 2 HDMI™ 3

Como espelhar o seu Google Pixel™ e mais funções:

Definições de Wireless
 Abra as definições de rede sem fios do seu dispositivo e procure o SSID do ScreenCast. Ligue ao SSID do ScreenCast e introduza a palavra-passe. A palavra-passe é exibida junto ao SSID no ecrã inicial.

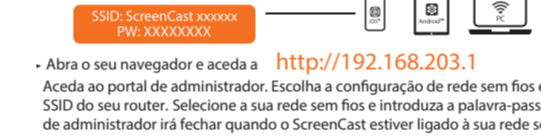

Abra o seu navegador e acesse <http://192.168.203.1>
 Aceda ao portal de administrador. Escolha a configuração de rede sem fios e procure o SSID do seu router. Seleccione a sua rede sem fios e introduza a palavra-passe. O portal de administrador irá fechar quando o ScreenCast estiver ligado à sua rede sem fios.

Rede sem fios configurada com êxito

A configuração da rede sem fios falhou

Como espelhar o seu dispositivo

Android™
 Abra o menu de definições rápidas e encontre a função de projeção do ecrã.

iOS®
 Abra o menu de definições rápidas e encontre a função de projeção do ecrã.

macOS®
 Execute a função "Airplay™" na barra de menus

Windows®
 Mantenha premidas as teclas Windows® + P e, em seguida, seleccione "Ligar a monitor sem fios" e seleccione o nome do dispositivo do ScreenCast.

Atualização do firmware

Notificação para atualização de firmware: Se existir uma atualização de firmware disponível, irá receber um aviso na parte superior, onde o ScreenCast indica o estado da ligação.

Atualização automática do firmware
 AVISO: Quando a transferência atingir 100% NÃO DESLIGUE A ALIMENTAÇÃO e aguarde que o sistema reinicie.

Atualização manual do firmware
 AVISO: Quando a transferência atingir 100% NÃO DESLIGUE A ALIMENTAÇÃO e aguarde que o sistema reinicie.

Para atualizar o firmware do seu ScreenCast, siga estas instruções:

Precisa de mais ajuda para configurar o ScreenCast? Visite j5create.com/screencast

Svenska

• Anslut till din TV och ström
 Anslut HDMI™-kontakten till en ledig HDMI™-port på TVn/bildskärmen
 Anslut USB™-kontakten till en ledig USB™-port A på din TV (USB™-förlängningskabel medföljer)
 * Om en USB™-port inte är tillgänglig på din TV kan du ansluta den till ett vägguttag med en USB™-adapter.

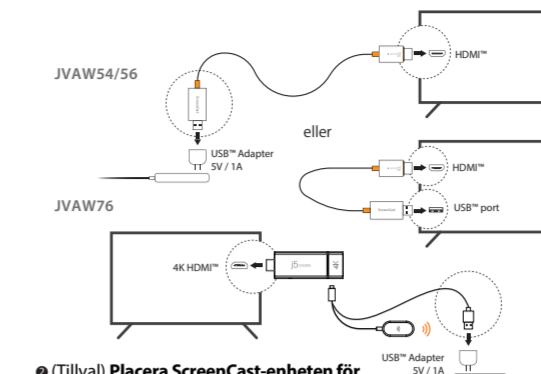

• (Tillval) Placera ScreenCast-enheten för optimal streamingupplevelse
 USB™-kontakten kan anslutas till din TV med den dubbelzijdige självhäftande remsan som medföljer. Remsan är för engångsbruk och kan tas bort. Vi rekommenderar INTE att du placerar USB™-kontakten bakom TV:n eller inuti ett TV-skåp. Om du gör det kan det orsaka svag signal eller sluttning.

Anvisningar för självhäftande remsan (JVAW54/56):

- 1** Välj en plan yta för att ansluta USB™-kontakten. Kontrollera att ytan är ren innan du fäster.
- 2** Ta bort skyddsremsan från den dubbelzijdige självhäftande remsan. Pressa limsidan mot USB™-kontaktens undersida.
- 3** Ta bort den andra skyddsremsan. Tryck ordentligt på USB™-kontakten på önskad plats i 30 sekunder.

• Slå på TV:n och välj ingång
 Slå på din TV för att starta ScreenCast-enheten och välj ingång tills du ser inställningsskärmen.
 * Om din TV-skärm förblir svart kan det handa att din TV inte levererar tillräckligt med ström. I detta fall, anslut USB™-sladden till en USB™-adapter och anslut den till ett uttag.



USB™ PC HDMI™ 1 HDMI™ 2 HDMI™ 3

Hur du spelar din Google Pixel™ och andra funktioner:

Wireless -inställningar
 Gå till din smartenhetens inställningar för trådlöst Internet och sök upp ScreenCasts SSID. Anslut till trådlöst Internet och ange lösenordet. PW-numret visas bredvid SSID:et på startskärmen.

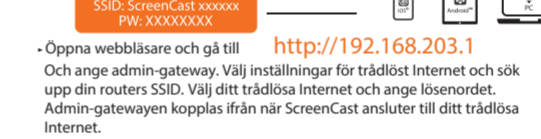

Öppna webbläsaren och gå till <http://192.168.203.1>
 Och ange admin-gateway. Välj inställningar för trådlöst Internet och sök upp din routers SSID. Välj ditt trådlösa Internet och ange lösenordet. Admin-gatewayen kopplas ifrån när ScreenCast ansluter till ditt trådlösa Internet.

Trådlöst Internet har ställts in

Trådlöst Internet kunde inte ställas in

Hur du speglar din enhet

Android™
 Dra ner snabbinställningsmenyn och sök upp skärmspeglingsfunktionen.

iOS®
 Svep för att öppna kontrollcentret och starta "Skärmspejling"

macOS®
 Starta "Airplay™" från menyfältet

Windows®
 Håll Windows®-tangenterna + P tryckta, och välj "Anslut till en trådlös skärm" och välj namnet på ScreenCast-enheten.

Firmware-upgradering

Avsättning om uppdatering för den fasta programvaran: Om det finns en tillgänglig uppdatering för den fasta programvaran kommer du att få ett meddelande överst på ScreenCast, som indikerar anslutningsstatusen.

Automatisk uppdatering av fast programvara
 VARNING: STÅNG INTE AV efter 100% nedladdning, utan vänta tills systemet startar om.

Manuell uppdatering av fast programvara
 VARNING: STÅNG INTE AV efter 100% nedladdning, utan vänta tills systemet startar om.

För att uppdatera den fasta programvaran för din ScreenCast, följ dessa instruktioner:

Behöver du mer hjälp med att ställa in ScreenCast-enheten? Besök j5create.com/screencast

Dansk

• Tilslut til dit tv og strømforbindelse
 Sæt HDMI™-stikket i en ledig HDMI™-port på dit tv/skærm
 Sæt USB™-stikket i en ledig USB™-Type-A-port på dit tv (USB™-forlængerkabel medfølger)
 * Hvis dit tv ikke har en USB™-port, kan du slutte den til en stikontakt med en USB™-strømadapter.

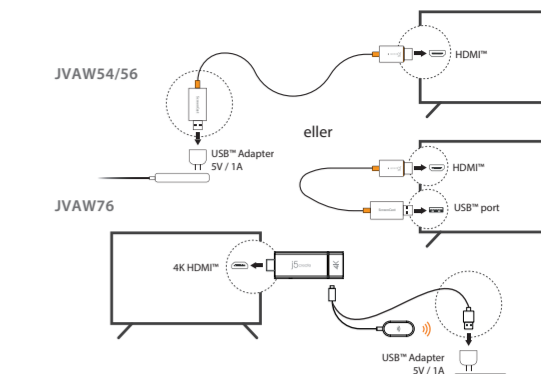

• (Ekstraudstyr) Sådan placeres din ScreenCast, så du får optimal streamingoplevelse
 USB™-stikket kan sluttes til tv med den dobbeltsidige dobbeltsidige klæbende strimmel. Strimlen er til engangsbrug og den kan tages af. Vi anbefaler IKKE at sætte USB™-kablet i en USB™-strømadapter og slutte det til en stikontakt med en USB™-strømadapter.

Vejledninger til de selvklæbende strimler(JVAW54/56)

- 1** Vælg en flad overflade, hvor USB™-stikket skal sættes på. Sørg for, at området er rent, før enheden sættes fast.
- 2** Fjern foringen på den dobbeltklæbende strimmel. Sæt den klæbende strimmel på bunden af USB™-stikket.
- 3** Fjern beskyttelsesstrimlen. Tryk USB™-stikket hårdt på den ønskede placering i 30 sekunder.

• Tænd for fjernsynet og vælg indgang
 Tænd fjernsynet for at starte ScreenCast og vælg indgang, indtil du ser opsætningskærmen.
 * Hvis tv-skærmen forbliver sort, forsyner fjernsynet muligvis ikke nok strøm. I dette tilfælde skal du sætte USB™-kablet i en USB™-strømadapter og slutte det til en stikontakt.



USB™ PC HDMI™ 1 HDMI™ 2 HDMI™ 3

Sådan spiller du din Google Pixel™ og flere funktioner:

Opsætning af trådløst internet
 Åbn indstillingerne for dit trådløse netværk på din enhed og søg efter ScreenCasts SSID. Forbind med ScreenCasts SSID og indtast adgangskoden. PW-nummeret vises under SSID'et på startskærmen.

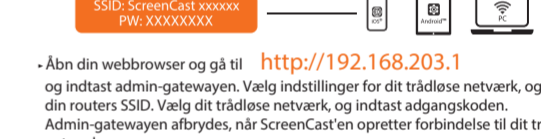

Åbn din webbrowser og gå til <http://192.168.203.1>
 og indtast admin-gatewayen. Vælg indstillinger for dit trådløse netværk, og søg efter din routers SSID. Vælg dit trådløse netværk, og indtast adgangskoden. Admin-gatewayen afbrydes, når ScreenCast er oprettet forbindelse til dit trådløse netværk.

Indstillingerne for dit trådløse netværk er blevet indstillet

Indstillingerne for dit trådløse netværk er ikke blevet indstillet

Sådan spejler du din enhed

Android™
 Træk ned i menuen Hurtige indstillinger og find skærmspejlfunktionen. Vælg derefter navnet på ScreenCast ens enhed.

iOS®
 Swipe for at åbne kontrolcentret og start "Skærmspejling" ved at vælge navnet på ScreenCast ens enhed.

macOS®
 Åbn "Airplay™" på menulinjen ved, at vælge navnet på ScreenCast ens enhed.

Windows®
 Hold tastene Windows® + P nede, og vælg "Opret forbindelse til en trådløs skærm" og vælg navnet på ScreenCast ens enhed.

Firmwareopdatering

Meddelelse om firmwareopdatering: Hvis der er en ny firmwareopdatering, får du en meddelelse foroven, hvor ScreenCast viser status på forbindelsen.

Automatisk firmware-opgradering
 ADVARSEL: Efter 100% download, må enheden IKKE SLUKKES. Vend indtil systemet genstartes.

Manuel firmwareopgradering
 ADVARSEL: Efter 100% download, må enheden IKKE SLUKKES. Vend indtil systemet genstartes.

Før at opdatere firmwaren på din ScreenCast, skal du følge disse instruktioner:

Har du brug for mere hjælp til, at opsætte ScreenCast? Gå på j5create.com/screencast

j5create

ScreenCast

Wireless Display Adapter (JVAW54/56)

4K Wireless Display Adapter (JVAW76)

JVAW54
JVAW56
JVAW76

j5create.com/screencast

STOP!

If you have any problems with this product, please contact our technical support team for assistance.

TECHNICAL SUPPORT

Customer Service: **888-988-0488**
 Technical Support: **888-689-4088**
 Email: **service@j5create.com**

SOPORTE TÉCNICO
 Número gratuito: +1-888-988-0488
 Horario de atención: Lun-Vier. 10:00 a.m – 6:00 U.S.A.-E.S.T
 Email: service@j5create.com

TECHNISCHER SUPPORT
 Kostenloser Anruf bei: +1-888-988-0488
 Sprechstunden: Mon.-Frei. 10:00 – 18:00 U.S.A.-E.S.T
 E-mail: service@j5create.com

テクニカルサポート
 お客様相談センター: 03-5540-9010
 電子メール: j5_support@solnet.co.jp
 テクニカルサポートやその他のご相談は下記の時間にご対応いたします。お気軽に申し上げます
 営業時間: 平日 9:30~11:30/13:30~17:30

TECHNICAL PODPORA
 Zákaznická linka: 888-988-0488
 Technická podpora: 888-689-4088
 E-mail: service@j5create.com

Kajiet Technology International B.V.
 Phone Number: +31-(0)6-2880 2882
 Address: Zomerdoorn 20,3068 MZ Rotterdam, Netherlands
 E-mail: service@j5create.com

TECHNIKAI SEGÍTSÉG
 Vevőszolgálat (angol nyelven): 888-988-0488
 Technikai támogatás (angol nyelven): 888-689-4088
 E-mail: service@j5create.com

SUPPORT TECHNIQUE
 Numéro gratuit: +1-888-988-0488
 Heures d'ouverture: Lun.-Ven. 10:00 a.m – 06:00 U.S.A.-E.S.T
 Email: service@j5create.com

技術支援資訊
 美國客服專線: +1-888-988-0488
 台灣客服專線: +886-2-2269-5533*19
 營業時間: 星期一至星期五 9:30 AM-6:00PM (台灣時間)
 Email信箱: service.tw@j5create.com

HDMI is a trademark of HDMI Licensing Administrator, Inc., its affiliates or its respective owners, registered or used in many jurisdictions worldwide. USB is a trademark of USB Implementers Forum, Inc., its affiliates or its respective owners, registered or used in many jurisdictions worldwide. IOS, macOS, iPhone, and AirPods are trademarks of Apple Inc., its affiliates or its respective owners, registered or used in many jurisdictions worldwide. Samsung is a trademark of Samsung Electronics Co., Ltd., its affiliates or its respective owners, registered or used in many jurisdictions worldwide. LG is a trademark of LG Electronics, its affiliates or its respective owners, registered or used in many jurisdictions worldwide. Other trademarks and trade names may be used in this document to refer to either the entire name or the marks and names of their products and are the property of their respective owners. All company, product and service names used are for identification purposes only. Use of these names, logos, and brands does not imply endorsement. We disclaim any interest in the marks of others.

FCC Warning Statements

This equipment has been tested and found to comply with the limits for a Class B digital device, pursuant to part 15 of the FCC Rules. These limits are designed to provide reasonable protection against harmful interference in a residential installation. This equipment generates, uses and can radiate radio frequency energy and, if not installed and used in accordance with the instructions, may cause harmful interference to radio communications. However, there is no guarantee that interference will not occur in a particular installation. If this equipment does cause harmful interference to radio or television reception, which can be determined by turning the equipment off and on, the user is encouraged to try to correct the interference by one or more of the following measures:

- Reorient or relocate the receiving antenna.
- Increase the separation between the equipment and receiver.
- Connect the equipment into an outlet on a circuit different from that to which the receiver is connected.
- Consult the dealer or an experienced radio/TV technician for help. This device complies with part 15 of the FCC Rules. Operation is subject to the following two conditions: (1) This device may not cause harmful interference, and (2) This device must accept any interference received, including interference that may cause undesired operation. changes or modifications not expressly approved by the party responsible for compliance could void the user's authority to operate the equipment.
- The USB-A port is only for the power supply? If USB-A port connect with a portable device, it just provides the power.

FCC RF Exposure Warning

This equipment should be installed and operated with a minimum distance of 20 centimeters between the radiator and your body.

The product is restricted for indoor use only.

NCC 警語

依據【低功率射頻器材技術規範】
 取得審驗證明之低功率射頻器材，非經核准，公司、商號或使用者均不得擅自變更頻率、加大功率或變更原設計之特性及功能。
 低功率射頻器材之使用不得影響飛航安全及干擾合法通信；經發現有干擾現象時，應立即停用，並改善至無干擾時方得繼續使用。
 前述合法通信，指依電信管理法規規定作業之無線電通信。
 低功率射頻器材須忍受合法通信或工業、科學及醫療用電波輻射性電機設備之干擾。

Limited Warranty

j5create offers a limited 1-year warranty. User's wear & tear damage is not included. The user shall call or email j5create customer service with the defect information of the product and obtain a return authorization number. Users are responsible for one-way return freight cost and we will take care of one-way freight back. In order to obtain a return authorization number, users should have the following information handy when calling or emailing the service team:

- a copy of the original purchase invoice to verify your warranty
- a product serial number
- a description of the problem
- customer's name, address, and telephone number

j5create does not warrant that the operation of the product will be uninterrupted or error-free. j5create is not responsible for damage arising from failure to follow instructions relating to the product's use. This warranty does not apply to: (a) consumable parts, unless damage has occurred due to a defect in materials or workmanship; (b) cosmetic damage, including but not limited to scratches, dents, and broken plastic on ports; (c) damage caused by use with non-j5create products; (d) damage caused by natural disasters; (e) damage caused by human misuse (lost, accident, abuse, misuse or other external causes); (f) damage caused by operating the product outside the permitted or intended uses described by j5create; (g) damage caused by service (including upgrades and expansions) performed by anyone who is not a representative of j5create or a j5create Authorized Service Provider; (h) a product or part that has been modified to alter functionality or capability without the written permission of j5create; or (i) if any j5create serial number on the product has been removed or defaced, if such a situation occurs. j5create will calculate the cost of materials and repair for your reference. This warranty is given by j5create in lieu of any other warranties expressed or implied.

Limitation of Warranty

THIS WARRANTY GIVES YOU SPECIFIC LEGAL RIGHTS, AND YOU MAY HAVE OTHER RIGHTS THAT VARY FROM STATE TO STATE (OR BY COUNTRY OR PROVINCE). OTHER THAN AS PERMITTED BY LAW, J5CREATE DOES NOT EXCLUDE, LIMIT OR SUSPEND OTHER RIGHTS YOU MAY HAVE, INCLUDING THOSE THAT MAY ARISE FROM THE NONCONFORMITY OF A SALES CONTRACT. FOR A FULL UNDERSTANDING OF YOUR RIGHTS YOU SHOULD CONSULT THE LAWS OF YOUR COUNTRY, PROVINCE OR STATE. TO THE EXTENT NOT PROHIBITED BY LAW IN YOUR STATE, PROVINCE, JURISDICTION OR COUNTRY, THIS WARRANTY AND THE REMEDIES SET FORTH ARE EXCLUSIVE AND IN LIEU OF ALL OTHER WARRANTIES, REMEDIES AND CONDITIONS, WHETHER ORAL, WRITTEN, STATUTORY, EXPRESS OR IMPLIED.

J5CREATE'S LIABILITY IN ANY SITUATION WILL BE NO MORE THAN THE AMOUNT YOU PAID FOR THE SPECIFIC PRODUCT THAT IS THE SUBJECT OF A CLAIM. THIS IS THE MAXIMUM AMOUNT FOR WHICH WE ARE RESPONSIBLE. EXCEPT FOR THE EXPRESS WARRANTIES CONTAINED IN THIS WARRANTY AND TO THE EXTENT NOT PROHIBITED BY LAW, J5CREATE DISCLAIMS ALL OTHER WARRANTIES AND CONDITIONS, EXPRESS OR IMPLIED, STATUTORY OR OTHERWISE, INCLUDING WITHOUT LIMITATION, WARRANTIES OF MERCHANTABILITY, MERCHANTABLE QUALITY AND FITNESS FOR A PARTICULAR PURPOSE AND WARRANTIES AND CONDITIONS AGAINST HIDDEN OR LATENT DEFECTS. SOME STATES, PROVINCES, JURISDICTIONS OR COUNTRIES DO NOT ALLOW DISCLAIMERS OF IMPLIED WARRANTIES AND CONDITIONS, SO THIS DISCLAIMER MAY NOT APPLY TO YOU.

TO THE EXTENT SUCH WARRANTIES AND CONDITIONS CANNOT BE DISCLAIMED UNDER THE LAWS OF THE UNITED STATES, CANADA (AND ITS PROVINCES) OR OTHERWISE, J5CREATE LIMITS THE DURATION AND REMEDIES OF SUCH WARRANTIES AND CONDITIONS TO THE DURATION OF THIS EXPRESS LIMITED WARRANTY AND, AT J5CREATE'S OPTION, REPAIR OR REPLACEMENT SERVICES. SOME STATES, PROVINCES, JURISDICTIONS OR COUNTRIES MAY NOT ALLOW LIMITATIONS ON HOW LONG AN IMPLIED WARRANTY OR CONDITION MAY LAST, SO THE LIMITATION DESCRIBED ABOVE MAY NOT APPLY TO YOU.

NO WARRANTIES OR CONDITIONS, WHETHER EXPRESS OR IMPLIED, WILL APPLY AFTER THE LIMITED WARRANTY PERIOD HAS EXPIRED. SOME STATES, PROVINCES, JURISDICTIONS OR COUNTRIES DO NOT ALLOW LIMITATIONS ON HOW LONG AN IMPLIED WARRANTY OR CONDITION LASTS, SO THIS LIMITATION MAY NOT APPLY TO YOU.

WARRANTY SUPPORT ONLY APPLIES WHEN THE COVERED PRODUCT IS LOCATED WITHIN THE COUNTRY IN WHICH J5CREATE ORIGINALLY SOLD THE SYSTEM, AS REFLECTED IN J5CREATE'S RECORDS. IF YOU NEED SUPPORT FOR THE PRODUCT OUTSIDE OF THE COUNTRY OF ORIGIN (FOR EXAMPLE, WHILE TRAVELING, OR IF THE SYSTEM HAS BEEN RELOCATED TO A NEW COUNTRY), THEN J5CREATE MAY OFFER YOU OTHER SUPPORT OPTIONS FOR AN ADDITIONAL CHARGE.

For more information please visit our website at <http://www.j5create.com>

Copyright © 2022 j5create. All rights reserved. All trade names are registered trademarks of their respective owners. Features and specifications are subject to change without notice. Product may not be exactly as shown in the diagrams.

Norsk

● Koble til TV og strøm

Koble HDMI™-kontakten til en tilgjengelig HDMI™-port på TV-en/skjermen
 Koble USB™-kontakten til en tilgjengelig USB™ Type-A-port på TV-en (USB™-forlengelseskabel følger med)
 * Hvis det ikke er en USB™-port tilgjengelig på TV-en, kan du koble den til en stikkontakt med en USB™-strømadapter.

● (Valgfritt) Plasser ScreenCast-enheten for en optimal strømmeopplevelse

USB™ Type-A-kontakten kan kobles til TV-en med den medfølgende dobbeltsidige selvklebende stripen. Stripen er til engangsbruk og kan tas av i anbefalt **IKKE** at USB™-kontakten plasseres bak TV-en eller inne i et TV-skap. Det kan føre til et svakt signal eller tap av signal.

Instruksjoner for selvklebende stripe (JVAW54/56)

- Velg en flat overflate for å koble til USB™-kontakten. Kontroller at området er rent for du fester.
- Fjern belegget fra den dobbeltsidige selvklebende stripen. Trykk limet til bunnen av USB™-kontakten.
- Fjern det andre belegget. Trykk USB™-kontakten til ønsket plassering i 30 sekunder.

● Slå på TV-en og velg inngang

Slå på TV-en for å slå på ScreenCast, og velg inngangen til du ser oppsettsskjermen.
 * Hvis TV-skjermen forblir svart, kan det hende at TV-en ikke gir nok strøm.
 I så fall må du koble USB™-ledningen til en USB™-strømadapter og koble denne til en stikkontakt.

Slå spiller du Google Pixel™ og film-funksjoner:
j5create.com/screencast

Sette opp trådløst internett

Gå til innstillingene for trådløst internett på enheten og søk etter SSID-en til ScreenCast. Koble til SSID-en til ScreenCast og skriv inn passordet. Passordet vises under SSID-en på hjem-skjermen.

SSID: ScreenCast xxxxxx
PW: XXXXXXXXXX

Åpne nettleseren og gå til <http://192.168.203.1> for å gå inn i admin-gatewayen. Velg innstillinger for trådløst Internett og søk etter SSID-en til ruten. Velg trådløst nettverk og angi passordet. Admin-gatewayen kobles fra når ScreenCast kobler til trådløst nettverk.

Slåk spiller du enheten

Android™
 Dra ned hurtiginnstillingsmenyen og finn skjermspillfunksjonen, og velg deretter ScreenCasts enhetsnavn.

iOS®
 Sveip for å åpne kontrollsentret og start «Skjermspilling» ved å velge ScreenCasts enhetsnavn.

macOS®
 Start «AirPlay» fra menylinjen ved å velge ScreenCasts enhetsnavn.

Windows®
 Trykk og hold inne Window™-tasten + P, velg «Koble til en trådløs skjerm» og velg ScreenCasts enhetsnavn.

Fastvareoppdatering

Varsling for fastvareoppdatering:
 Hvis fastvareoppdatering er tilgjengelig, vil du motta en melding på toppen der ScreenCast indikerer tilkoblingsstatusen.

Automatisk fastvareoppgradering

⚠ ADVARSEL: Når nedlastingen er 100% må du **IKKE SLÅ AV**. Vent til systemet starter på nytt.

Last ned fastvare: Download: 85%
 Oppgrader fastvare: Upgrade: 35%

Manuell fastvareoppdatering

⚠ ADVARSEL: Når nedlastingen er 100% må du **IKKE SLÅ AV**. Vent til systemet starter på nytt.

For å oppdatere fastvare til ScreenCast følger du instruksjonene nedenfor:

SSID: ScreenCast xxxxxx
PW: XXXXXXXXXX

⚠ ADVARSEL: Når nedlastingen er 100% må du **IKKE SLÅ AV**. Vent til systemet starter på nytt.

Last ned fastvare: Download: 85%
 Oppgrader fastvare: Upgrade: 35%

Trenger du mer hjelp til å sette opp ScreenCast?
 Besøk [j5create.com/screencast](http://www.j5create.com/screencast)

Suomi

● Liitä TV-vastaanottimeen ja virtalähteeseen

Liitä HDMI™-liitin TV:n/näytön käytettävissä olevaan HDMI™-porttiin
 Liitä USB™-liitin TV:n käytettävissä olevaan USB™ Type-A-porttiin (USB™-jatkokaapeli kuuluu toimitukseen)
 * Jos TV:ssä ei ole käytettävissä USB™-porttia, Voit liittää sen pistorasiaan käyttämällä USB™-verkkoliitettä.

● (Valinnainen) sijoita ScreenCast saadakseen striimauskokemuksen

USB™-liittimen voi kiinnittää TV-vastaanottimeen toimitukseen kuuluvalla kaksipuolisella teipillä. Teippi on kertakäyttöinen eikä sitä voi poistaa.
 Me **EMME** suositella USB™-liittimen sijoittamista TV:n taakse tai TV-koteloon sisään. Jos niin tehdään, seurauksena voi olla heikko signaali tai signaalin menetykset.

Teipinkäyttöohjeet (JVAW54/56)

- Valitse tasainen pinta USB™-liittimen kiinnittämiseen. Varmista ennen kiinnittämistä, että alue on puhdas.
- Irrota suojakalvo kaksipuolisesta liimainauhasta. Paina teippi USB™-liittimen pohjaan.
- Poista toinen suojakalvo. Paina USB™-liitin lujasti haluttuun kohtaan 30 sekuntia.

● Kytke TV päälle ja valitse tulo

Kytke TV päälle käynnistäksesi ScreenCastin ja valitse tulo, kunnes näet asetusnäytön.
 * Jos TV:n kuvaruutu pysyy mustana, TV ei ehkä saa riittävästi virtaa.
 Tässä tapauksessa liitä USB™-johto USB™-verkkoliitteesen ja liitä se pistorasiaan.

Google Pixel™-n peilaaminen ja muita toimintoja:
j5create.com/screencast

Langaton internet-asetus

Siirry laitteen langattomiin internet-asetuksiin ja etsi ScreenCastin SSID. Yhdistä ScreenCast SSID-tunnukseen ja syötä salasana. PW (Salasana) -numero näkyy aloitussyöttössä SSID:n alapuolella.

SSID: ScreenCast xxxxxx
PW: XXXXXXXXXX

Avaa verkkoselain ja siirry osoitteeseen <http://192.168.203.1> ja syötä järjestelmänvalvojan yhdyksikäyttövä. Valitse langattomat internet-asetukset ja etsi reitittimessä SSID-tunnus. Valitse langaton internet-yhteytesi ja syötä salasana. Järjestelmänvalvojan yhdyksikäyttöväyhteys katkeaa, kun ScreenCast muodostaa yhteyden langattomaan internetiin.

Laitteesi peilaaminen

Android™
 Vedä pika-asetukset-valikko auki ja valitse ScreenCastin laitenimi.

iOS®
 Pyyhkäise avataksesi Ohjauskeskus ja käynnistä "Näytön peilaaminen" valitsemalla ScreenCastin laitenimi.

macOS®
 Käynnistä "AirPlay" valikkopalkista valitsemalla ScreenCast laitenimi.

Windows®
 Pidä Window™-näppäin + P -näppäinyhdistelmää painettuna ja valitse "Yhdistä langattomaan näyttöön" ja valitse ScreenCastin laitenimi.

Laiteohjelmistopäivitys

Ilmoitus laiteohjelmistopäivityksestä: Jos laiteohjelmistopäivitys on käytettävissä, saat ilmoituksen yläreunaan, jossa ScreenCast ilmaisee yhteytilaan.

Automaattinen laiteohjelmistopäivitys

⚠ VAROITUS: 100% latauksen jälkeen **ÄLÄ KATKAISE VIRTAA**. Odota järjestelmän uudelleenkäynnistymistä.

Lataa laiteohjelmisto: Download: 85%
 Automaattinen laiteohjelmistopäivitys: Upgrade: 35%

Manuaalinen laiteohjelmistopäivitys

⚠ VAROITUS: 100% latauksen jälkeen **ÄLÄ KATKAISE VIRTAA**. Odota järjestelmän uudelleenkäynnistymistä.

Päivittäksesi ScreenCastin laiteohjelmiston, toimi seuraavien ohjeiden mukaisesti:

SSID: ScreenCast xxxxxx
PW: XXXXXXXXXX

Lataa laiteohjelmisto: Download: 85%
 Automaattinen laiteohjelmistopäivitys: Upgrade: 35%

Besoin de plus d'aide pour mettre en place le ScreenCast?
 Visitez [j5create.com/screencast](http://www.j5create.com/screencast)

Magyar

● Csatlakoztassa a TV-hez és a tápfeszültséghez

Csatlakoztassa a HDMI™-csatlakozót a TV-készülék/megjelenítő egyik szabad HDMI™-aljzatához
 Csatlakoztassa az USB™-csatlakozót a TV egyik szabad USB™ Type-A aljzatához (USB™ hosszabbító kábel mellékelve)
 * Ha a televízióján nincs USB™-aljzat, akkor USB™ tápfeszültség-adapterrel csatlakoztathatja a készüléket egy fali konnektorhoz.

● (Opcionális) A ScreenCast elhelyezése az optimális streaming élmény érdekében

Az USB™-csatlakozó a mellékelt kétoldalas ragasztócsikkal rögzíthető a TV-hez. A csik egyszer használatos és eltávolítható.
NEM javasoljuk az USB™-csatlakozó elhelyezését a TV mögött vagy TV-szekrény belsejében. Ez gyenge jelet vagy jelvesztést okozhat.

Adhesive Strip Instructions (JVAW54/56)

- Válasszon sík felületet az USB™-csatlakozó rögzítéséhez. A rögzítés előtt győződjön meg arról, hogy a terület tiszta.
- Távolítsa el a másik hátlapot. Nyomja erősen az USB™-csatlakozót a kívánt helyre 30 másodpercig. Nyomja a ragasztócsikot az USB™-csatlakozó aljára.
- Távolítsa el a másik hátlapot. Nyomja erősen az USB™-csatlakozót a kívánt helyre 30 másodpercig.

● Accensione del televisore e selezione dell'ingresso

Kapcsolja be a TV-t a ScreenCast bekapcsolásához, majd válasszon bemenetet, amíg meg nem jelenik a beállítási képernyő.
 * Ha a TV-képernyő fekete marad, elképzelhető, hogy a TV esetleg nem szolgáltat elegendő energiát. Ebben az esetben kérjük, csatlakoztassa az USB™-kábel egy USB™ tápfeszültség-adapterhez, majd csatlakoztassa azt egy konnektorhoz.

A Google Pixel™-n tápközlés és további funkciók:
j5create.com/screencast

Vezeték nélküli internet beállítása

Lépjön be a készülék vezeték nélküli internetbeállításába, és keresse meg a ScreenCast SSID-jét. Csatlakozza a ScreenCast SSID azonosítójával, és adja meg a jelszót. A jelszócím a kezdőképernyőn az SSID alatt látható.

SSID: ScreenCast xxxxxx
PW: XXXXXXXXXX

Avassa meg a webböngészőt, és lépjen a <http://192.168.203.1> címre, majd adja meg az admin átjárót. Válassza a vezeték nélküli internetbeállításokat, és keresse meg az útválasztó SSID-jét. Válassza ki a vezeték nélküli internetet, és adja meg a jelszót. Az Admin átjáró megszaktja a kapcsolatot, amikor a ScreenCast csatlakozik a vezeték nélküli internethez.

Hogyan tükrözheti készülékét?

Android™
 Húzza lefelé a gyorsbeállítások menüt, és keresse meg a képernyőtükörlés funkciót, majd válassza ki a ScreenCast eszköz nevét.

iOS®
 Legyintse a képernyőt a Vezérlőközpont megnyitására, majd indítsa el a „Screen Mirroring” funkciót a ScreenCast eszköz nevének kiválasztásával.

macOS®
 Indítsa el az „Airplay”-t a menüsorból a ScreenCast eszköz nevének kiválasztásával.

Windows®
 Nyomja meg és tartsa lenyomva a Windows™ billentyűt + P kombinációt, majd válassza a „Csatlakozás vezeték nélküli kijelzőhöz” lehetőséget, és válassza ki a ScreenCast eszköz nevét.

Firmware-frissítés

Értesítés a firmware-frissítésről: Ha elérhető firmware-frissítés, akkor a ScreenCast tetjében, ahol a ScreenCast jelzi a kapcsolat állapotát, megjelenik egy értesítés.

Automatikus firmware-frissítés

⚠ FIGYELEM: A 100%-os letöltés után kérjük, **NE KAPCSOLJA KI A KÉSZÜLÉKET**. Várja meg, amíg a rendszer újraindul.

Firmware letöltése: Download: 85%
 Firmware frissítése: Upgrade: 35%

Kézi firmware-frissítés

⚠ FIGYELEM: A 100%-os letöltés után kérjük, **NE KAPCSOLJA KI A KÉSZÜLÉKET**. Várja meg, amíg a rendszer újraindul.

A ScreenCast firmware-frissítéséhez kövesse az alábbi utasításokat:

SSID: ScreenCast xxxxxx
PW: XXXXXXXXXX

Firmware letöltése: Download: 85%
 Firmware frissítése: Upgrade: 35%

További segítségre van szüksége a ScreenCast beállításához?
 Látogasson el a [j5create.com/screencast](http://www.j5create.com/screencast) oldalra

Беспроводной HDMI™ адаптер Screencast (JVAW54/56) / Беспроводной 4K HDMI™ адаптер Screencast (JVAW76)

- Технические особенности
- Беспроводная передача контента с мобильного устройства на ТВ
- Встроенная поддержка AirPlay™, Miracast™ и Chromecast™ (Google Cast™)

Подключение к ТВ
Вставьте HDMI™ разъем в свободный HDMI™ порт на ТВ/дисплее

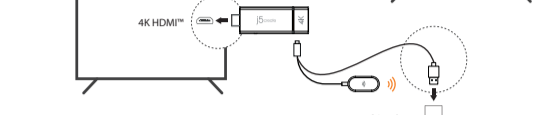
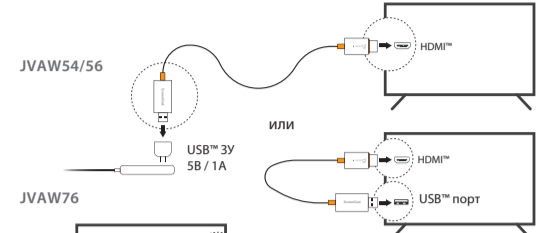

Расположите Screencast для получения наилучшего качества сигнала

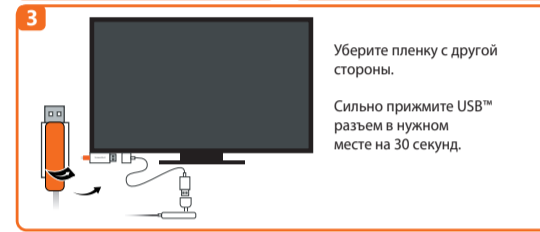

Включите ТВ и выберите источник сигнала



Настройка беспроводного Интернета

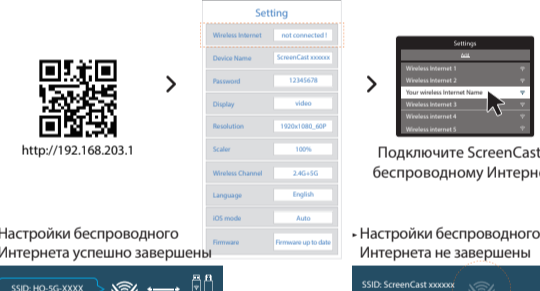
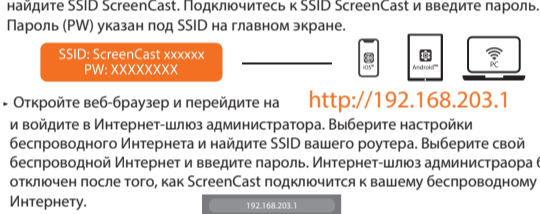

Как дублировать экран

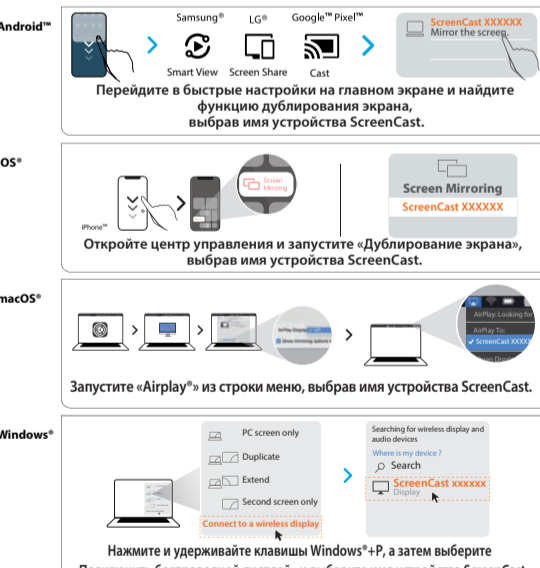

Обновление прошивки

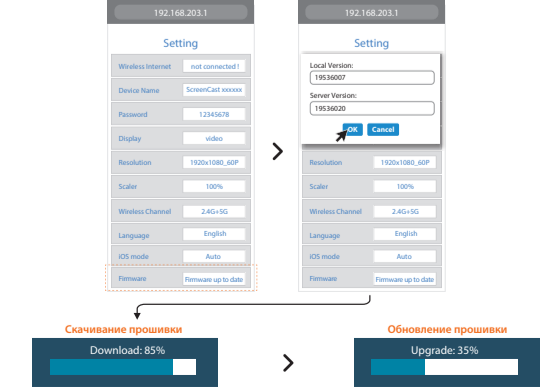
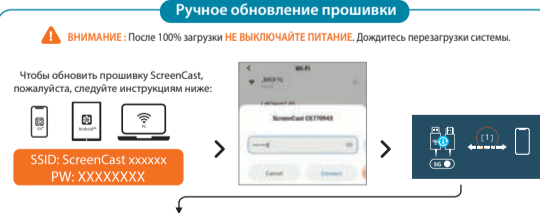
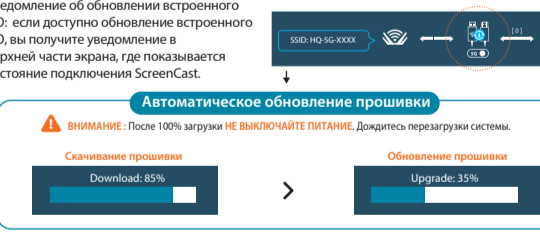

Нужна дополнительная помощь в настройке ScreenCast? Посетите jScreate.com/screencast

テレビと電源に接続する

HDMI™ コネクタをテレビ/ディスプレイにある HDMI™ ポートに接続します。
USB™ コネクタをテレビにある USB™ タイプ A ポートに接続します

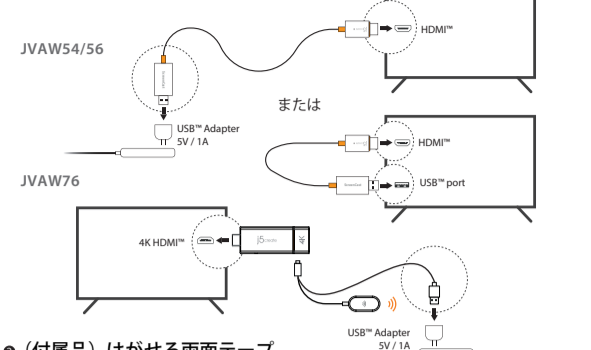

(付属品) はがせる両面テープ
USB端子側を固定することで配線がスッキリ

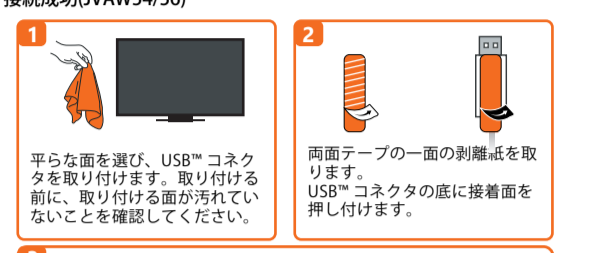

テレビの電源を入れ、入力を選択する

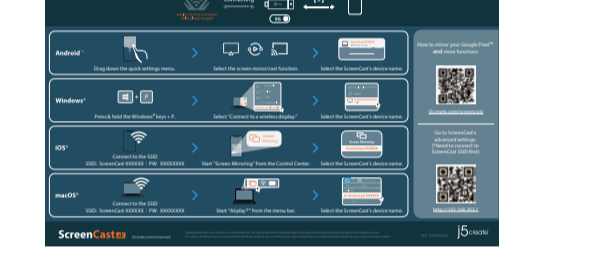

初期設定方法



デバイスをミラーリングする方法

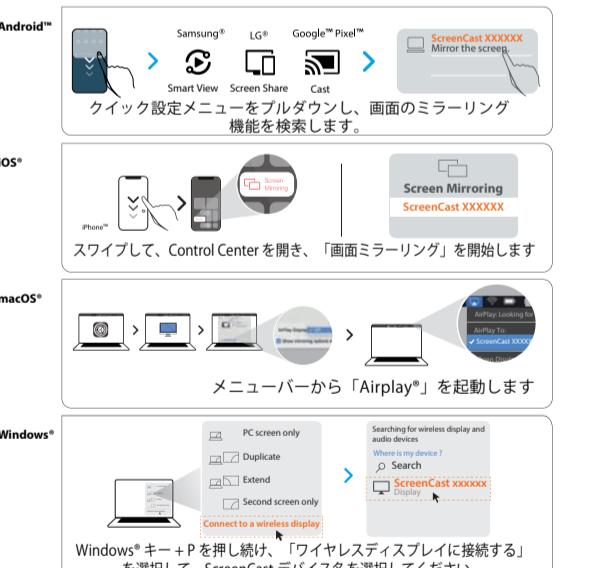

ファームウェアのアップグレード

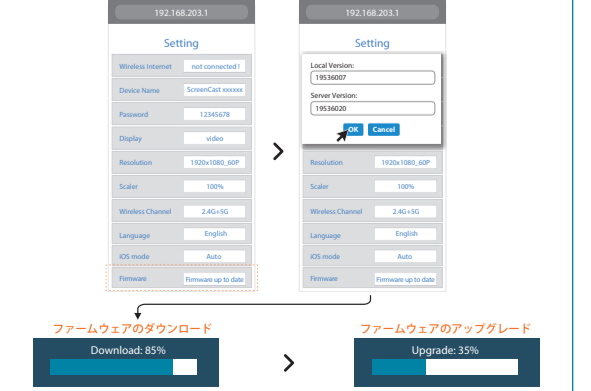
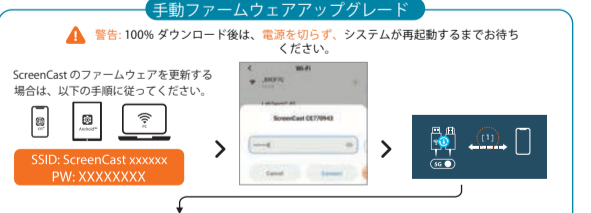
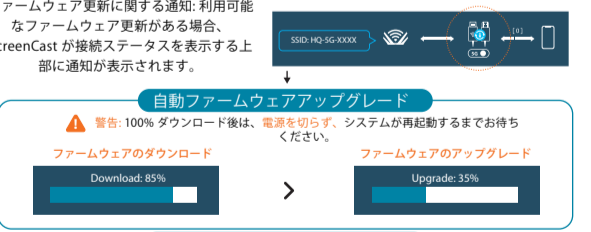

ScreenCastの設定について他のご質問がありますか? jScreate.com/screencastにアクセスしてください

連接電視及電源

HDMI™ 端連接到電視/投影機的 HDMI™ 埠
將 USB™ 端連接到 USB™ Type-A 埠

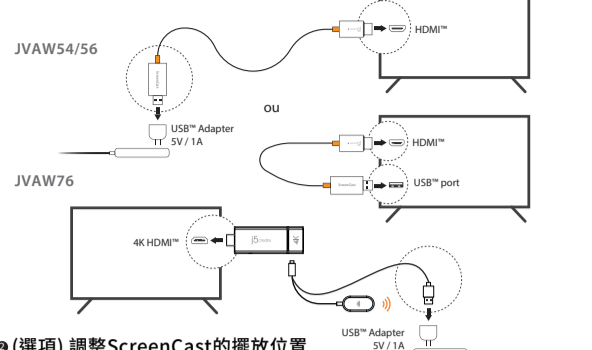

(選項) 調整ScreenCast的擺放位置
以獲得最佳的媒體投射體驗



打開電源並選擇ScreenCast連接至電視HDMI™孔相對應的訊號源

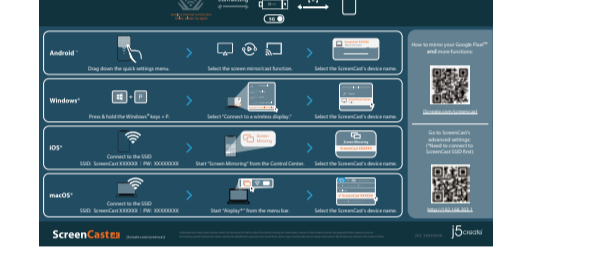

無線網路設定



如何鏡像投射您的智慧裝置

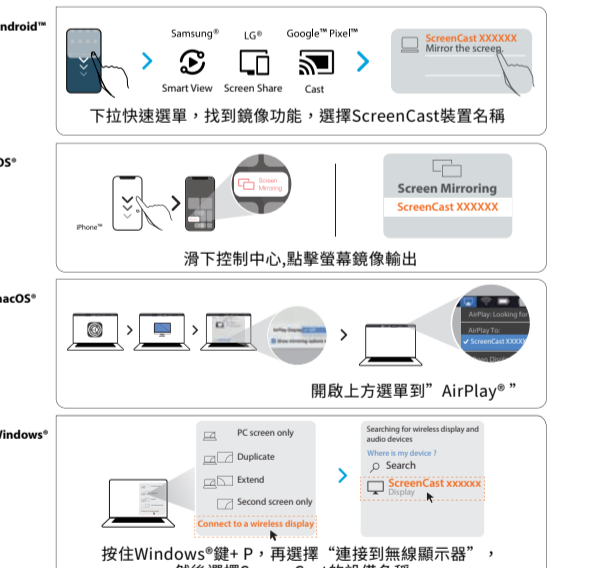

韌體更新



需要更多協助來設置ScreenCast嗎? jScreate.com/screencast

连接电视及电源

HDMI™ 端連接到電視/投影機的 HDMI™ 埠
將 USB™ 端連接到 USB™ Type-A 埠

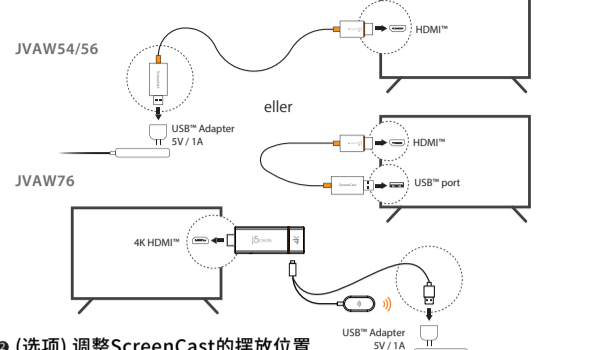

(选项) 调整ScreenCast的摆放位置
以获得最佳的媒体投射体验

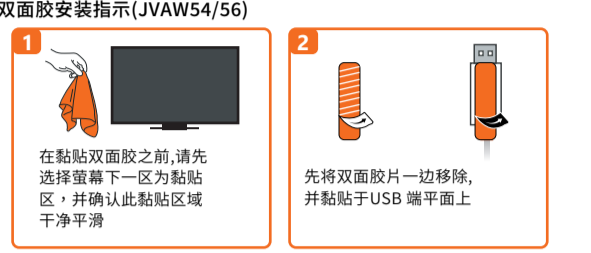

打开电源并选择ScreenCast连接至电视HDMI™孔相对应的讯号源

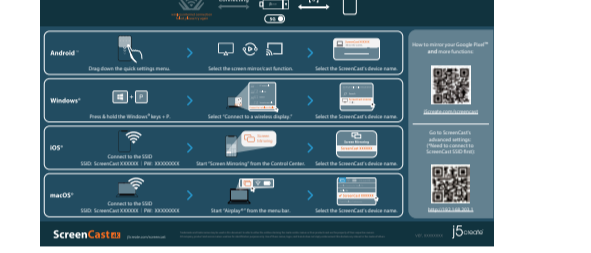
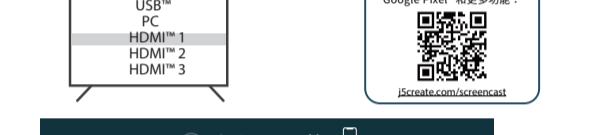

无线网路设定



如何鏡像投射您的智慧裝置

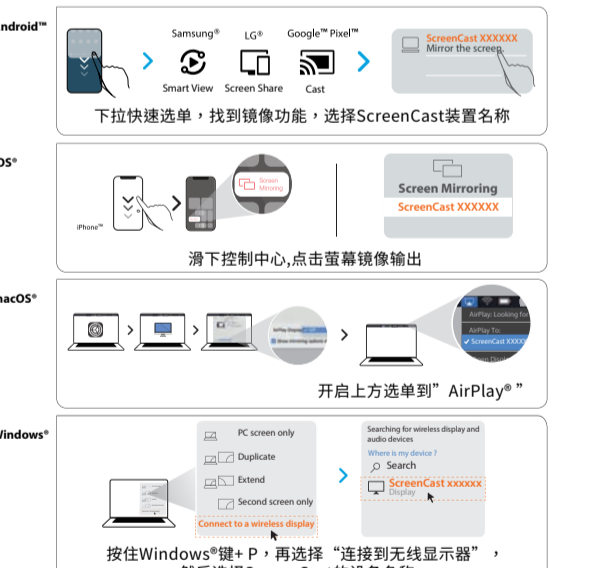

韌體更新



需要更多協助來設置ScreenCast嗎? jScreate.com/screencast