



### DISPLAY

Diagonal Size	65" 4K, 75" 4K, 86" 4K
Screen Type	TFT LCD (Direct LED Backlight)
Aspect Ratio	16:9
Display Area	65" 4K: 1429 x 804 mm (56.3 x 31.7 in) 75" 4K: 1652 x 930 mm (65 x 36.6 in) 86" 4K: 1895 x 1066 mm (74.6 x 41.9 in)
Display Colours	1.07 Billion
Resolution	4K UHD (3840 x 2160 @ 60 Hz)
Response Time	8 ms
Panel Refresh Rate	60 Hz
LED Lifespan	50,000 hours
LCD Viewing Angle	178°
Brightness	65" 4K: 350 cd/m2 75" 4K: 350 cd/m2 86" 4K: 400 cd/m2
Contrast Ratio	4000:1
Ambient Light Sensor	Yes
Glass Hardness	9H (pencil), 7 (Mohs)
Glass Type	Heat-tempered, Anti-Glare

### INTERACTIVITY

Angled Centre Console	Yes, with Power, Volume Control, Menu, Freeze, No Touch, Source Selection Buttons
Touch Technology	Vellum™ Writing Technology
Continuous Touch Points	20
Touch Resolution	32768 x 32768 px
Response Time	10 ms
Touch Accuracy	1 mm
Tracking Rate	4 m/s
Scan Rate	100 Hz
Gestures and Edge Swipes	Windows® Supported
Pens Included	2
Pen Type	Battery-less Pen
Pen Holder	Integrated Full-length Pen Tray
Pen Tip Diameter	3 mm
Pen and Touch Differentiation	Yes
Pen Identities	1
Palm Detection	Yes
Annotation Over Any Source	Yes
Classroom Essential Apps	Including Whiteboard, Annotate, Timer, Spinner, Screen Capture, Screen Share, Browser, PDF Reader, Media Players
Compatibility	Windows® 8 to 10; OS X® 10.8 to 10.11; macOS® Sierra 10.12.1 or later; Linux® Ubuntu® 18.04 LTS; Chrome OS™

### CONNECTIVITY

HDMI® 2.0 In (Rear)	1
HDMI 2.0 In (Front)	1
HDMI 2.0 Out	1
Display Port 1.2 In	1
VGA In	1
VGA Audio In	1
USB-A 2.0 (Rear)	2
USB-A 2.0 (Front)	1
USB-A 3.0 (faster data transfer, Front)	1 (OPS)
USB-B Touch (Rear)	1
USB-B Touch (Front)	1
USB-C PD2.0, USB 2.0, DP1.2 (Rear)	1
LAN In (RJ45)	1x 10/100 Mbps
LAN Out (RJ45)	1x 10/100 Mbps
Wake-on-LAN	Yes
Wi-Fi® Module IEEE® 802.11a/b/g/n/ac Wireless, 2x2	Included
RS-232	Yes
CVBS	1
Mic In (3.5 mm)	1
Headphone	1
OPS Slot	1

### COMPUTING

Operating System	Android™ Oreo 8
RAM	3 GB
Internal Storage	32 GB
CPU	Quad Core: (2) ARM Cortex A73, (2) ARM Cortex A53
GPU	ARM Mali-G51 MP2
Remote Over-the-Air Updates	Yes
Promethean Panel Management	Yes

### AUDIO

Dual Front Facing Speakers	2 x 15 Watts
----------------------------	--------------

### POWER

Power Requirements	100V - 240V AC
Power Consumption (Maximum)	65" 4K: 235W 75" 4K: 380W 86" 4K: 450W
Power Consumption (Standby)	<=0.5 W
Ultra-Quiet Fanless Design	Yes

### ENVIRONMENTAL

Operating Temperature	0°C to 40°C (32°F to 104°F)
Storage Temperature	-15°C to 55°C (-5°F to 131°F)
Operating Humidity	20% to 80% non-condensing humidity
Storage Humidity	20% to 90% non-condensing humidity

### PHYSICAL SPECIFICATIONS

Panel Dimensions	65" 4K: 1536 x 960 x 90 mm (60.5 x 37.8 x 3.5 in) 75" 4K: 1767 x 1093 x 106 mm (69.6 x 43.0 x 4.2 in) 86" 4K: 2018 x 1236 x 113 mm (79.4 x 48.7 x 4.4 in)
Packed Dimensions	65" 4K: 1720 x 1095 x 272 mm (67.7 x 43.1 x 10.7 in) 75" 4K: 1880 x 1160 x 320 mm (74.0 x 45.7 x 12.6 in) 86" 4K: 2140 x 1340 x 280 mm (84.3 x 52.8 x 11.0 in)
Net Weight	65" 4K: 46 kg (101 lbs) 75" 4K: 62 kg (137 lbs) 86" 4K: 82 kg (181 lbs)
Packed Weight	65" 4K: 66kg (146lbs) 75" 4K: 85kg (187lbs) 86" 4K: 106kg (233 lbs)
Wall Mount Dimensions	1010 x 720 x 52 mm (39.8 x 28.3 x 2.0 in)
VESA Mount Point	65" 4K: 600 x 400 mm (23.6 x 15.7 in) 75" 4K: 600 x 400 mm (23.6 x 15.7 in) 86" 4K: 700 x 400 mm (27.6 x 15.7 in)

### COMPLIANCE & CERTIFICATION

Regulatory Certifications	CE, FCC, IC, UL, CUL, CB, RCM
Energy Star Certified	65" 4K: Yes 75" 4K: Yes 86" 4K: Yes

### EDUCATION SOFTWARE LICENSE

ActivInspire® Professional Single User	Included
--	----------

### PACKED CONTENTS

What's in the Box	(1) ActivPanel Cobalt (1) 3M Length HDMI Cable (1) 3M Length USB Cable (A-B) (1) 3M Regional Power Cable (1) 2M Length USB-C Cable (1) Remote Control (2) Batteries for Remote Control (2) ActivPanel Cobalt Pens (1) Sealed Antistatic Bag (4) VESA mount screws (M6) (1) Mini PC Bracket with screws (1) Quick Install Guide (1) Promethean Wi-Fi Module (Ni/Co) (2) Antenna (1) Promethean Wi-Fi Module (Ni/Co) User Guide (1) Wall Mount
-------------------	--

### INSTALLATION

The installation of this product should be completed by a qualified installer. Use of components not supplied by Promethean or not meeting minimum specifications may impact performance, safety and warranty. For more information, visit Support. PrometheanWorld.com.

### WARRANTY

Warranty term and upgrade options vary by region. Contact your local reseller or distributor for information and visit PrometheanWorld.com/Warranty.

### SUPPORT

For all Promethean products, visit Support.PrometheanWorld.com.

TECHNICAL DRAWINGS

65"

Front

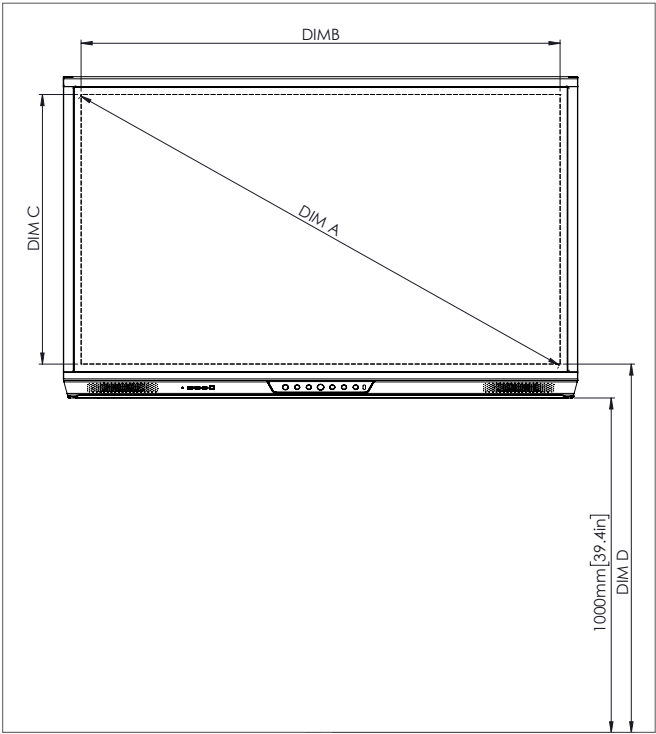

DIM	DIMENSION (MM)	DIMENSION (IN)
A	1641	64.6
B	1430	56.3
C	805	31.7
D	1101	43.3
E	133	5.2
F	83	3.3
G	960	37.8
H	1536	60.5
I	600	23.6
J Min	151	5.9
J Max	289	11.4
K Min	1151	45.3
K Max	1289	50.7
L	90	3.5

Back

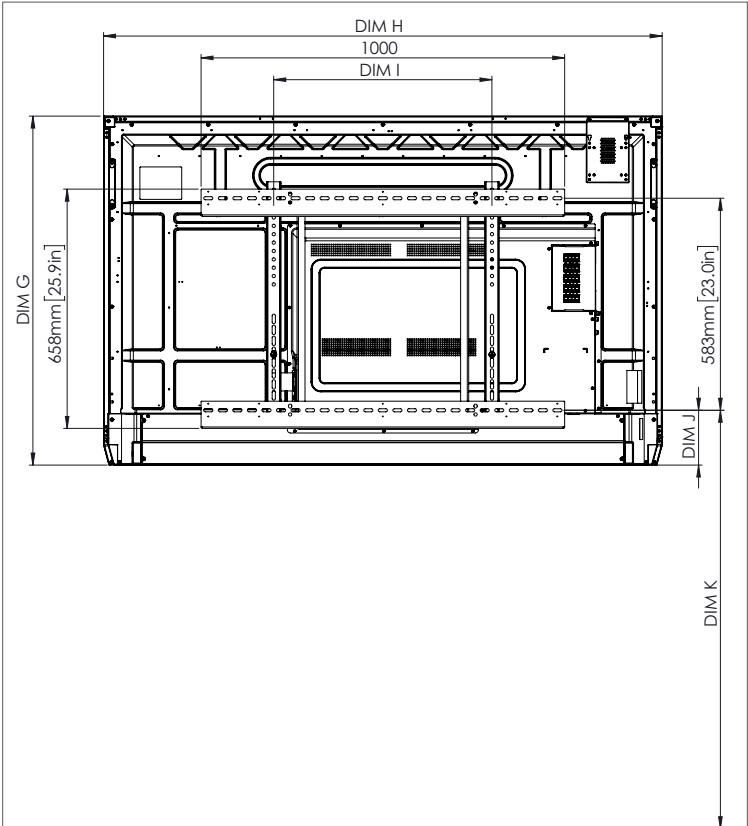

Side

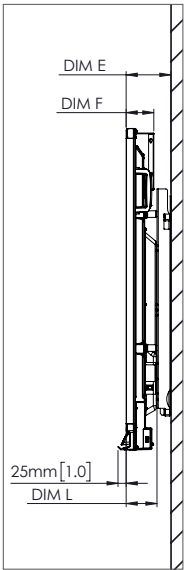

TECHNICAL DRAWINGS

75"

Front

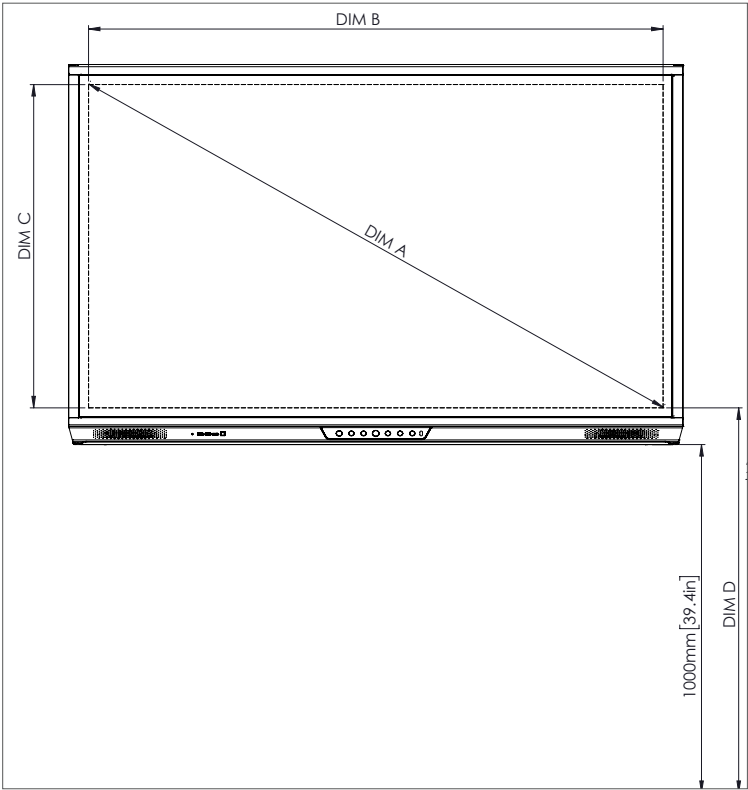

DIM	DIMENSION (MM)	DIMENSION (IN)
A	1895	74.6
B	1652	65.0
C	929	36.6
D	1105	43.5
E	144	5.7
F	76	3.0
G	1093	43.0
H	1767	69.6
I	600	23.6
J Min	228	9.0
J Max	365	14.4
K Min	1228	48.3
K Max	1365	53.7
L	106	4.2

Back

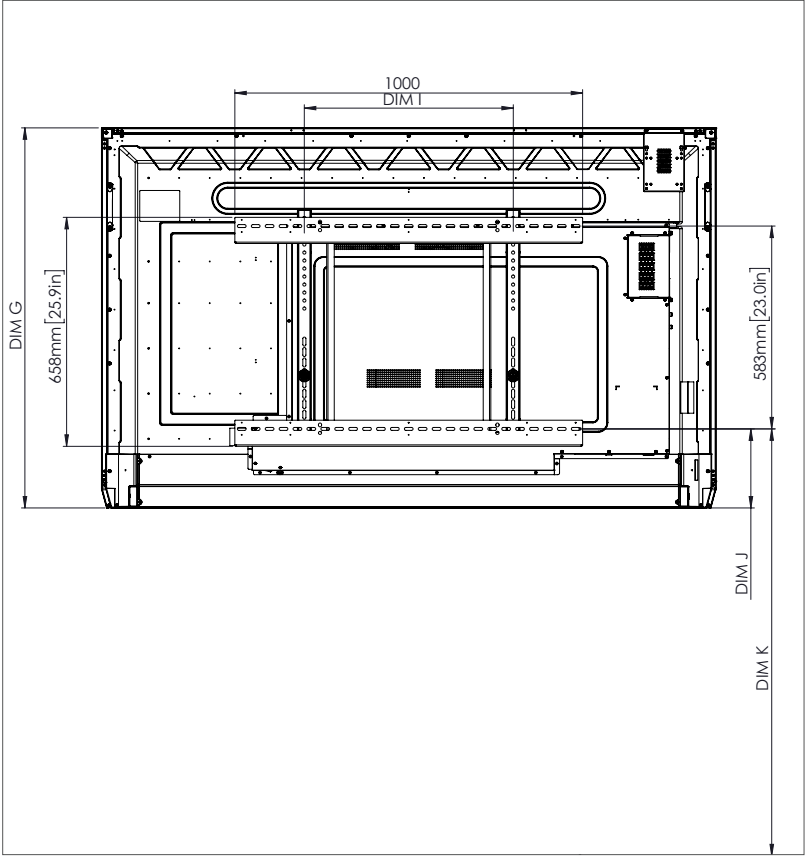

Side

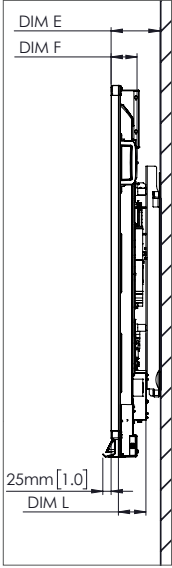

TECHNICAL DRAWINGS

86"

Front

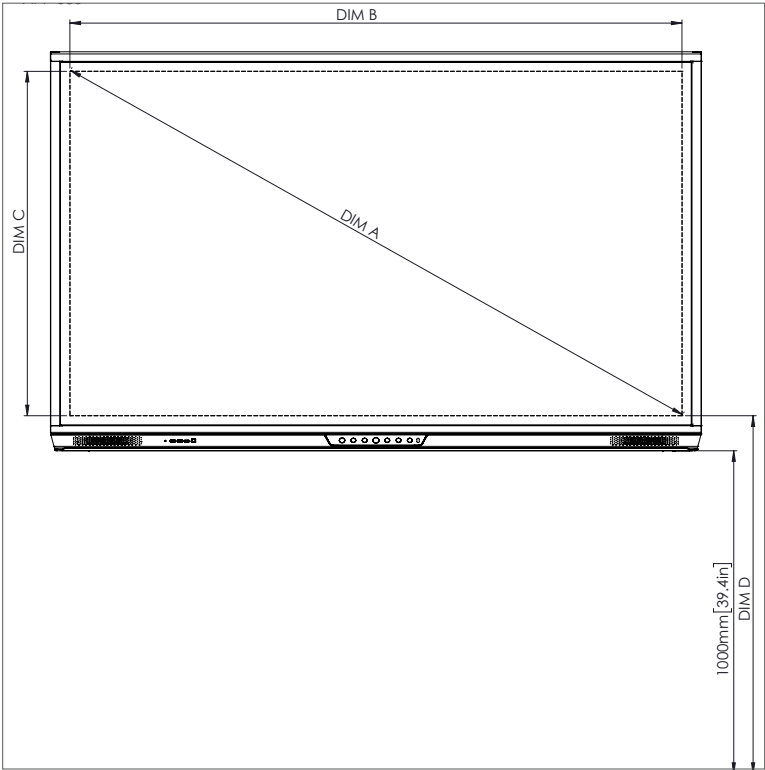

DIM	DIMENSION (MM)	DIMENSION (IN)
A	2177	85.7
B	1897	74.7
C	1067	42.0
D	1107	43.6
E	155	6.1
F	78	3.1
G	1236	48.7
H	2018	79.4
I	700	27.6
J Min	292	11.5
J Max	430	16.9
K Min	1292	50.9
K Max	1430	56.3
L	113	4.4

Back

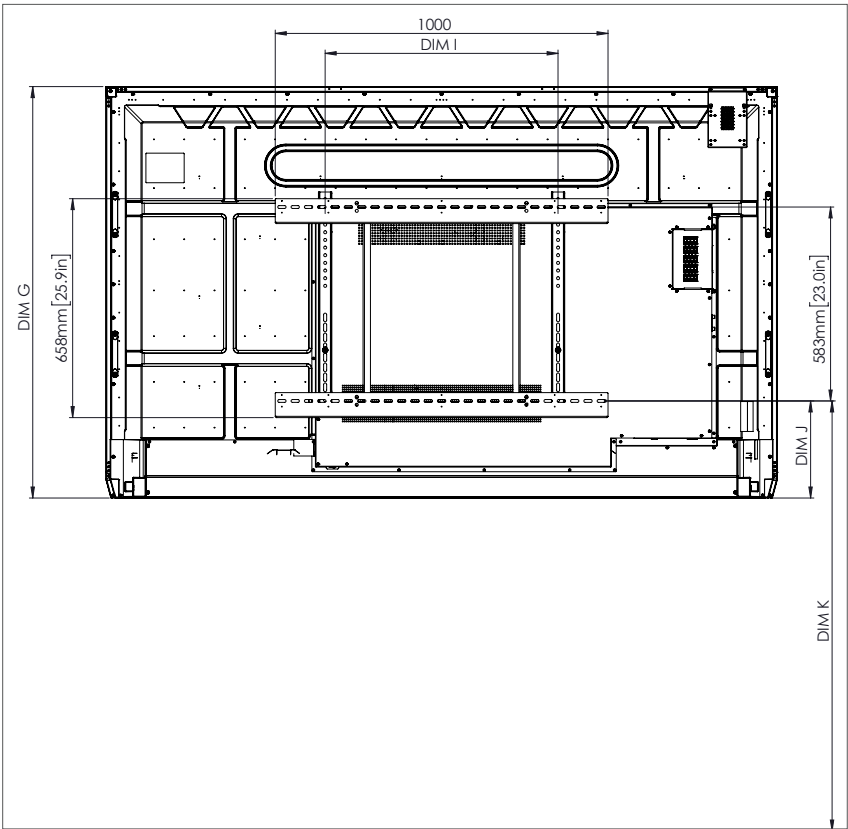

Side

