



## Lindy Wall Mount Bracket

**Brand :** Lindy

**Product code:** 40875

**Product name :** Wall Mount Bracket

- VESA Mounting Standard: 5 / 7,5 / 10cm
  - Distance from the wall to the unit: about 7cm
  - Swiveling (-30 ° to + 30 °) and tiltable (-5 ° to + 15 °)
  - Material: powder-coated steel
  - Colour: black
- Monitor and TV wall mount, pivots and tilts

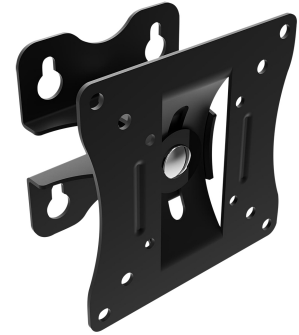

### Lindy Wall Mount Bracket:

VESA Mounting Standard: 5 / 7,5 / 10cm

Distance from the wall to the unit: about 7cm

Swiveling (-30 ° to + 30 °) and tiltable (-5 ° to + 15 °)

Material: powder-coated steel

Colour: black

Lindy Wall Mount Bracket. Maximum weight capacity: 15 kg, Minimum VESA mount: 50 x 50 mm, Maximum VESA mount: 100 x 100 mm. Tilt angle range: -5 - 15°, Swivel angle range: -30 - 30°, Distance to the wall (min): 7 cm. Product colour: Black

Mounting		Ergonomics	
Maximum weight capacity *	15 kg	Distance to the wall (min)	7 cm
Minimum VESA mount *	50 x 50 mm	Design	
Maximum VESA mount *	100 x 100 mm	Product colour *	Black
Panel mounting interface	50 x 50,75 x 75,100 x 100	Housing material	Steel
Number of displays supported	1	Certification	CE, FCC
Mounting type *	Wall	Packaging content	
Ergonomics		Manual	✓
Tilt angle range	-5 - 15°	Logistics data	
Swivel angle range	-30 - 30°	Harmonized System (HS) code	85299097



4002888408752

Disclaimer. The information published here (the "Information") is based on sources that can be considered reliable, typically the manufacturer, but this Information is provided "AS IS" and without guarantee of correctness or completeness. The Information is only indicative and can be changed at any time without notification. No rights can be based on the Information. Suppliers or aggregators of this Information do not accept any liability with regard to the content of (web)pages and other documents, including its Information. The publisher of the Information can not be held liable for the content of 3rd party websites that are linking this Information or are linked to from this Information. You as the User of the Information are solely responsible for the choice and usage of this Information. You are not entitled to transfer, copy or otherwise multiply or distribute the Information. You are obliged to follow the directions of the copyright owner(s) with regard to the use of the Information. Exclusively Dutch law is applicable. With regard to price and stock data on the site, the publisher followed a number of starting points, which are not necessarily relevant for your private or business circumstances. Therefore, the price and stock data are only indicative and are subject to changes. You are personally responsible for the way you use and apply this information. As a user of the Information or sites or documents in which this Information is included, you will adhere to standard fair use including avoidance of spamming, ripping, intellectual-property violations, privacy violations, and any other illegal activity.

Publication date: 19-JAN-2023. Prints or copies of Information are only valid on the printed Publication date